

MEYER GAGE COMPANY

2019 CATALOG



Phone: 800-243-7087

www.meyergage.com

Fax: 860-528-1428

ISO 9001 Certified
Accredited Calibration Services

CONTENTS

<i>DESCRIPTION</i>	<i>PAGE</i>	<i>DESCRIPTION</i>	<i>PAGE</i>
THE ABC'S OF PLUG GAGES, GAGE MAKER'S TOLERANCE CHART	5	TRILOCK STYLE GAGES.....	25
PLUG GAGE USE, PFP SERVICE, PLUG GAGE TOLERANCE & SELECTION	6	CUSTOM PROGRESSIVE GAGES	26
CALIBRATION PRICE LIST	7	MASTER SETTING DISCS	27
INDIVIDUAL CLASS Z GAGE PINS INDIVIDUAL CLASS X, XX GAGE PINS	8	THREAD MEASURING WIRES	28
ENGLISH GO/NOGO GAGES WITH HANDLES, METRIC GO/NOGO GAGES WITH HANDLES	9	GEAR MEASURING WIRES	29
BLACK OXIDE COATED CLASS ZZ GO/NOGO GAGES	10	3-WIRE THREAD MEASURING SYSTEM	30-31
GAGE HANDLES & ACCESSORIES	11	TAPERLOCK STEEL THREAD PLUG GAGES	32-34
ENGLISH CLASS Z GAGE SETS	12	TRILOCK REVERSIBLE STEEL THREAD PLUG GAGES	35
ENGLISH CLASS Z LIBRARY SETS	13	HELICAL COIL TAPERLOCK STEEL GAGES (STI)	36
CLASS ZZ BLACK OX GAGE SETS	14	REVERSIBLE STEEL THREAD PLUG GAGES	37
CLASS ZZ BLACK OX LIBRARY SETS	15	THREAD RING GAGES (ENGLISH).....	38-39
METRIC CLASS Z GAGE SETS	16	TRUNCATED THREAD SETTING PLUGS.....	40-41
METRIC CLASS Z LIBRARY SETS	17	METRIC STEEL TAPERLOCK THREAD PLUG GAGES	42
ENGLISH CLASS X GAGE SETS	18	REVERSIBLE METRIC STEEL THREAD PLUGS	43
ENGLISH CLASS X LIBRARY SETS, CLASS X MG-25 SERIES	19	THREAD RING GAGES (METRIC)	44
CUSTOM LENGTH CLASS ZZ GAGES	20	THREAD SETTING PLUGS (METRIC).....	45
CUSTOM LENGTH CLASS X GAGES	21	TAPER PIPE GAGES — NPT	46
GAGE STORAGE ACCESSORIES, HEAVY DUTY METAL STORAGE CABINETS.....	22	TAPER PIPE GAGES — NPTF	47
RING GAGES	23	TABLE OF THREAD PITCH DIAMETER LIMITS	48-49
TAPERLOCK STYLE GAGES	24	DECIMALS & METRIC EQUIVALENTS	50



WARRANTY:

Meyer Gage warrants all gages for 30 days from date of shipment, except in cases of customer error, misuse or mishandling. This 30 day period allows ample time for all gages to be inspected for any manufacturing inaccuracies. MEYER GAGE MAKES NO OTHER WARRANTIES OR CONDITIONS ON THE PRODUCTS, EXPRESS, IMPLIED, OR STATUTORY AND MEYER GAGE HEREBY EXPRESSLY DISCLAIMS ALL OTHER WARRANTIES INCLUDING, WITHOUT LIMITATION, THE IMPLIED WARRANTIES OF MERCHANTABILITY AND FITNESS FOR A PARTICULAR PURPOSE

CERTIFICATIONS:

Contact us when you need a quote for calibration services or view our price list on page 7. We will gladly provide you a copy of our laboratory scope and uncertainties. The laboratory environment is maintained at 68° degree Fahrenheit (+/- 0.5°) 24/7 365 days a year. The laboratory has successfully completed an A2LA evaluation process and accreditation has been granted Certificate Number 3340.01 per ISO/IEC 17025:2005 standards

Terms of sale: CONDITIONS:

In the event of nonconforming or defective goods or of any claimed loss or damage, buyer's sole remedy and measure of damages shall be the return of the within goods and repayment of the purchase price, or the replacement of nonconforming or defective goods or parts. In no event shall buyer be entitled to consequential damages.

The ABC's of Plug Gages

The ABC's of Plug Gages

Plug Gage Measuring - the art of using pre-sized precision metal plugs to determine the acceptability of diameters of drilled or machined holes.

Go/NOGO Measurement - A GO gage is used to check the lower limit of a hole. A NOGO gage is used to check the upper limit of a hole. If the GO gage enters the hole and the NOGO gage is unable to enter, the design specifications of the hole have been met.

Uses - for precision GO/NOGO measuring of hole sizes and depths, checking hole location and distance, and setting micrometers. All gages are uniformly 2" long with ground ends, allowing you to use both ends for increased gage life. Gages are Carbon Chrome Alloy Steel (grade 52100 bearing quality steel) and heat treated to a 60-62 Rockwell C hardness. All of our products come with a Certificate of Class Conformance, traceable to NIST (National Institute for Standards Technology). The size and "+" (GO) or "-" (NOGO) are laser etched with a Meyer Exclusive Serial Number feature to ensure traceability on your shop floor on all gages that are .061" and larger.

Class ZZ Gages - These gages have an inch tolerance of .0002" and a metric tolerance of .005mm. They are practical where good precision and speed are important.

Class Z Gages - These gages have an inch tolerance of .0001" and a metric tolerance of .0025mm. They are one half the deviation of the ZZ, for a better fit.

Class X Gages - These gages are available with an inch tolerance of .00004" and a metric tolerance of .001mm. These gages are used where greater precision is needed.

Class XX Gages - These gages have an inch tolerance of .00002" and a metric tolerance of .0005mm. They are one half of the deviation of the X. Great for your most critical needs.

Length and Finish - All gages are 2 inches or 51mm long with ground ends for long life.

52100 Steel - This is bearing quality, Carbon Chrome Alloy Steel heat treated to 60-62 Rockwell C hardness and is considered the preferred material for the highest quality plug gages.

Certificate of Class Conformance - Assurance issued with each shipment of quality gages that conformance characteristics are traceable to NIST.

NIST - National Institute of Standards and Technology

Serial Number Etching - A feature that is exclusive to Meyer Gages and essential in assuring traceability on the shop floor on all gages that are 0.061" and larger.

Information on How to Take Care of your Meyer Gage

Clean the part before gaging. Get rid of dirt, coolant, and chips.
Protect the gage from damage. Nicks and burrs allow inaccurate results.

Do not force the gage. Use light pressure.
Keep gages clean and oiled. This increases wear life.

Avoid handling gaging surfaces. Fingerprints cause rust.

Gage Maker's Tolerance Chart

Plain Plug, Plain Ring & Master Gage Tolerances

Range (English)	XXX	XX	X	Y	Z	ZZ
.005" to .8250"	.000010	.000020"	.000040"	.000070"	.000100"	.000200
.8251" to 1.5100"	.000015	.000030"	.000060"	.000090"	.000120"	.000240"
1.5101" to 2.5100"	.000020	.000040"	.000080"	.000120"	.000160"	.000320"
2.5101" to 4.5100"	.000025	.000050"	.000100"	.000150"	.000200"	.000400"
4.5101" to 6.5100"	.000033	.000065"	.000130"	.000190"	.000250"	.000500"
6.5101" to 9.0100"	.000040	.000080"	.000160"	.000240"	.000320"	.000640"
9.0101" to 12.2600"	.000050	.000100"	.000200"	.000300"	.000400"	.000800"
Range (METRIC)	XXX	XX	X	Y	Z	ZZ
0.21mm to 21.00mm	.00025mm	.00051mm	.00102mm	.00178mm	.00254mm	.00508mm
21.01mm to 38.00mm	.00038mm	.00076mm	.00152mm	.00229mm	.00305mm	.00610mm
38.01mm to 64.00mm	.00051mm	.00102mm	.00202mm	.00305mm	.00406mm	.00813mm
64.01mm to 115.00mm	.00064mm	.00127mm	.00254mm	.00381mm	.00508mm	.01016mm
115.01mm to 165.00mm	.00084mm	.00165mm	.00330mm	.00483mm	.00635mm	.01270mm
165.01mm to 230.00mm	.00102mm	.00203mm	.00406mm	.00610mm	.00813mm	.01626mm
230.01mm to 300.00mm	.00127mm	.00254mm	.00508mm	.00762mm	.01016mm	.02032mm

NOTE: Cylindrical plug gage tolerance is GO (Plus) and NOGO (Minus).
 Master cylindrical plug gage tolerance is 50% Plus, 50% Minus.
 Master Setting Disc tolerance is 50% Plus, 50% Minus.
 Cylindrical plain ring gage tolerance is GO (Minus) and NOGO (Plus).



PLUG GAGE USE

When using plug gages for GO NOGO inspection the GO member should fit into the work piece to indicate to the operator that the component meets the correct specifications. The NOGO member should not fit into the work piece. If it does this indicates to the operator that the component has been machined incorrectly and is out of specification.

For this reason the GO gage is usually selected close but above the lower limit size of the component and the NOGO gage is usually selected just under the high limit of the component.

For example: a component that has a size specification of 0.250" to 0.255". The GO gage in this example may be selected to be a 0.250"(+) plus gage pin and the NOGO pin gage selected as a 0.255"(-) minus plug gage.

These gages, if Class Z, will range from 0.2500" to 0.2501" for the GO, and the NOGO gage will fall within a tolerance range size of 0.2550" to 0.2549".

The use of the GO and NOGO gages are used to inspect the component for a pass or fail process only, and will not measure the exact size of the hole or slot in the component. As in the above example, some "good parts" can actually fail the GO / NOGO test if they fall below the actual gage size within the tolerance or class of the gage. Below is described a standard practice for selection of the Class of tolerance gage pins with a certain tolerance component.

Premium Factory Processing Service

Meyer Gage continues to work hard to meet the expectations of our customers for product quality, responsiveness, and competitive pricing - while supplying the very finest fixed limit gages.

To further our commitment to you, we offer expediting services for orders requiring same-day processing and shipment, or rush services on custom made products. These special services will be charged a Premium Factory Processing Fee (35% of the net total order). Depending on the time, quantity and complexity of your order, shipping may be delayed until the following business day. While Meyer Gage cannot guarantee same-day shipment for all orders, we make every reasonable attempt to meet these shortened deadlines. (Shipping charges from the carrier of your choice are in addition to this service)

Plug Gage Tolerance & Selection

Standard practice in American industry is to allow 5% of the component hole tolerance for the GO gage tolerance and 5% for the NOGO gage tolerance. The GO gage, whose nominal size is at the low limit of the hole to be checked is generally given a plus tolerance in order to insure that all parts accepted fall within the product tolerance.

For the same reason the NOGO gage, whose nominal is at the high limit of the product tolerance, is given a minus tolerance. In this age of strict product liability, perhaps it is better to reject a few acceptable parts than to pass any out-of-tolerance parts. The GO gage plus tolerance and the NOGO minus tolerance have become universal in American industry and 10% of the hole tolerance (5% at each end) is sacrificed to insure that all pieces accepted are within tolerance.

There can be several reasons for using finer or coarser tolerances that the 10% rule would dictate. In a case where the production process is such that a significant number of acceptable parts are expected to fall into either of the 5% areas of product tolerance which may be rejected due to gage tolerance, a tighter tolerance should be considered. The value of these parts or the effort necessary to re-inspect them weighed against the cost of a finer gage (such as Class X, Class XX, or Class XXX) can more than justify the cost of the finer tolerance.

What Plug Gages Are...

1. Used to inspect holes or slots for pass or fail conditions only.
2. Used as masters for setting micrometers, verniers, or calipers.

What Plug Gages Are Not...

1. Used to measure the exact or actual size.
2. Resizing tools, or reamers.
3. Deburring tools, or clean out tools.



Calibration Price List:

Date: 8/12/2013 Cert #: 14882



MEYER GAGE COMPANY INC.
Certificate of Calibration

Calibration Performed By: MEYER GAGE COMPANY, INC.
 230 BURRHAM STREET
 SOUTH WINDSOR, CT, 06074

YOUR COMPANY NAME
 123 MAIN STREET
 ANY TOWN, ST 00000-0000

Purchase Order: 12345 Equipment: AEROL LASER XLS 40
 Description: CLZ INCH CYLINDRICAL PLUG GAGES
 Manufacturer: MEYER GAGE COMPANY INC. Condition of Gage: NEW
 Gage Type: CLZ Line of Measure: INCH
 Model Number: Tolerance: ASME B89.1.5 - 1998
 Temp. RH: 67.8 F (43.9 Performed By: MELISSA LEE
 Cal. Interval: 06.000 Months Cal. Due Date:
 Cal Date: 8/12/2013 Calibration Result: PASS
 Calibration Method Used: MEYER 01

Measurements taken using Aerol Kartrol Laser Scan Microscoper serial number XLS 40 date calibrated 06/17/2013, calibration due date 06/17/2014. Master gage pins serial number(s) MEYER-1-1, 127000-1-1, 302238-1-1 date calibrated 04/03/2013, calibration due date 04/03/2014.

Dimension	Tolerance	Dimension 1	Mean	StdDev	Spec	Actual Pass
0.1250	± 0.0010	0.125100	0.12504	0.12506	0.12508	AS2
0.2500	± 0.0010	0.250100	0.25004	0.25006	0.25008	BR9
0.5000	± 0.0010	0.500100	0.50004	0.50006	0.50008	JR5
0.7500	± 0.0010	0.750100	0.75004	0.75006	0.75008	MD3

This certificate, and the calibration performed, meets or exceeds requirements set forth in ISO/IEC 17025. Measurements made conform to the tolerance specifications listed in ANSI B89.1.5-1998 unless listed as otherwise. The material/gaging covered by this certification, has been compared to masters traceable to SI Units through master gages controlled by calibration schedule. The expanded uncertainty associated with this measurement is 10 microns - using a coverage factor of K=2 which provides confidence level of approximately 95%. This certification is neither a contract or a contractual representation. Meyer Gage Co.'s responsibility, in no event whatsoever, shall exceed the purchase price of this calibration. This report may not be copied or reproduced except in full, without written approval from the Meyer Gage Company Inc.

Inspected By: _____ Calibration Technician
 Reviewed By: _____ Calibration Technician

Page 1 of 1 Cert #: 14882

A2LA 17025 Certifications Per Piece Price

PLUG & RINGS GAGES

	New	Customer
Class ZZ or Z Pin Set	\$ 1.48	\$2.50
Class ZZ or Z Individual Pins	\$ 4.00	\$5.50
Class XX or X Pin Set	\$11.77	\$18.00
Class XX or X Individual Pins	\$22.25	\$35.00
Master Setting Discs (per Dimension)	\$35.00	\$45.00
Trilock Gage (all Classes)	\$35.00	\$45.00
Taperlock Gage (all Classes)	\$35.00	\$45.00
Progressive Gage (all Classes)	\$70.00	\$90.00
Ring Gage (Catalog Offering)	\$45.00	\$60.00
Custom Length Class ZZ	\$ 8.00	\$14.00
Custom Length Class X	\$35.00	\$45.00

THREAD WIRE & GEAR WIRE PRODUCTS

	New	Customer
Thread Wire Sets (3 wires)	\$35.00	\$45.00
Gear Wire Sets (2)	\$35.00	\$45.00

Certificate of Class/Conformance (compliance)

This certificate states that a specific gage or set of gages has been inspected by comparison with Master Gages traceable to the National Institute of Standards & Technology and found to be within the required tolerance. This certificate does not give exact size. Certificates of Conformance are available on new gages only. Certificate of Conformance certifies that a gage, as listed, is within proper tolerances and proper physical condition. (Furnished FREE with all orders from Meyer Gage)

Calibrations Traceable to NIST and/or 17025

Certificate of Calibration (long form certificate) gives exact size to specified tolerance. Certificates of Calibration are available with new or used gages after inspection. Calibration Certificates show actual gage measurements. Each certificate is numbered to match a number we etch on the gage providing traceability between the gage and the Certificate where gage size permits.

NIST Traceable Certifications Per Piece Price

THREADED PRODUCTS

	New	Customer
Thread Plugs up to 1-1/2"	\$50.00	\$80.00
Thread Plugs over 1-1/2" to 4"	\$65.00	\$95.00
Thread Plugs over 4"	\$70.00	\$120.00
Thread Rings up to 1-1/2"	\$50.00	\$80.00
Thread Rings over 1-1/2" to 4"	\$65.00	\$95.00
Thread Rings over 4"	\$70.00	\$120.00

PIPE PRODUCTS

	New	Customer
Pipe Plugs up to 2"	\$60.00	\$75.00
Pipe Plugs over 2"	\$75.00	\$85.00
Pipe Rings up to 2"	\$60.00	\$75.00
Pipe Rings over 2"	\$75.00	\$85.00



Individual Class Z Gage Pins*

Replace missing pins! Don't live with broken sets. We stock these replacement pins in even and half-thousand sizes for immediate shipment. All pins over 0.060"/1.51mm are laser marked with size and direction of tolerance. But we don't stop there. We've also added a serial number lasered onto each piece for traceability.

English

.005	to	.0105	\$ 8.68
.011	to	.0605	3.95
.061	to	.5005	3.53
.501	to	.6255	4.84
.626	to	.7505	7.04
.751	to	.8325	10.55
.833	to	.9165	12.06
.917	to	1.0150	12.47



IMPORTANT: Specify PLUS or MINUS
when ordering individual members.
*Size increments available in
0.0005"/0.01mm

Metric

.22mm	to	1.51mm	\$ 4.84
1.52	to	12.71	4.40
12.72	to	15.31	5.54
15.32	to	17.81	8.69
17.82	to	20.37	10.45
20.38	to	22.05	12.23
22.06	to	23.73	13.70
23.74	to	25.41	15.41



Individual Class X, XX Gage Pins*

These pins have the same features as our Class Z pins, but with a 0.00004" tolerance limit and a 0.00002" roundness limit. They are great for your inspection needs or when you want to maximize your GO/NOGO tolerance limit. They're also a great way to calibrate measuring equipment, micrometers and calipers. We make all sizes for your special needs. All pins over 0.060" or 1.51 mm are laser marked with size and direction of tolerance. We've also added a serial number lasered onto each piece for traceability.

When an even tighter tolerance is needed, Meyer Gage makes XX pin gages. With a tolerance of 0.00002" and a roundness limit of 0.00001", it's our tightest tolerance yet for your most critical inspection needs. They're our best gages to calibrate your measuring equipment, micrometers and calipers. All pins over 0.060" or 1.51mm are laser marked with size and direction of tolerance. We've also added the serial number for traceability.



Inch	Class X	2-5	6-9	10&up	Class XX	2-5	6-9	10&up
.0110" to .07599"	\$17.47	\$16.60	\$15.73	\$14.85	\$34.93	\$33.19	\$31.44	\$ 29.69
.0760" to .50099"	14.12	\$13.42	\$12.71	\$12.01	28.25	\$26.84	\$25.42	\$ 24.01
.5010" to .74999"	20.07	\$19.07	\$18.06	\$17.06	40.13	\$38.12	\$36.11	\$ 34.11
.7500" to 1.0000"	24.89	\$23.64	\$22.40	\$21.15	49.78	\$47.30	\$44.81	\$ 42.32
Metric	Class X	2-5	6-9	10&up	Class XX	2-5	6-9	10&up
0.220mm to 1.909mm	\$17.47	\$16.60	\$15.73	\$ 14.85	\$34.93	\$33.19	\$31.44	\$ 29.69
1.910mm to 12.709mm	14.12	\$13.42	\$12.71	\$ 12.01	28.25	\$26.84	\$25.42	\$ 24.01
12.710mm to 19.029mm	20.07	\$19.07	\$18.06	\$ 17.06	40.13	\$38.12	\$36.11	\$ 34.11
19.030mm to 25.400mm	24.89	\$23.64	\$22.40	\$ 21.15	49.78	\$47.30	\$44.81	\$ 42.32

Please specify **PLUS** or **MINUS**. Also available **Class X, XX BILATERAL** (split tolerance). Add 25% to prices shown. Combine identical sizes within given Class for quantity price break.



English GO/NOGO Gages with Handle



Price Range	Diameter Range	Class Z GO		Class X GO		Class XX GO	
		Class Z GO/NOGO Ass'y. (220A)	Assembly <i>or</i> NOGO Ass'y. (225B)	Class X GO/NOGO Ass'y. (230C)	Assembly <i>or</i> NOGO Ass'y. (235D)	Class XX GO/NOGO Ass'y. (236I)	Assembly <i>or</i> NOGO Ass'y. (237J)
1	0.0110" to 0.0755"	\$ 21.04	\$ 13.89	\$50.48	\$ 27.92	\$ 100.97	\$ 55.81
2	0.0760" to 0.1805"	20.85	13.43	43.92	24.63	87.83	49.25
3	0.1810" to 0.2815"	22.40	14.78	44.33	25.04	88.65	50.06
4	0.2820" to 0.4065"	22.84	15.24	45.55	25.85	91.12	51.72
5	0.4070" to 0.5005"	26.43	18.36	48.85	27.92	97.68	55.81
6	0.5010" to 0.5105"	28.67	18.81	61.96	34.48	123.99	68.94
7	0.5110" to 0.6255"	34.92	23.30	67.71	39.40	135.43	78.80
8	0.6260" to 0.6355"	39.67	25.98	67.71	39.40	135.43	78.80
9	0.6360" to 0.7505"	41.92	27.76	69.77	41.06	139.56	82.09
10	0.7510" to 0.7605"	49.08	31.35	80.44	46.38	160.87	92.74
11	0.7610" to 0.8325"	60.00	40.30	89.39	53.77	178.75	107.53
12	0.8330" to 0.9165"	61.79	42.09	89.39	53.77	178.75	107.53
13	0.9170" to 1.0005"	63.13	43.88	89.39	53.77	178.75	107.53

Order in 4 Easy Steps:

List Product Group **Ex: 225B**

Price Range **4**

Size Needed **.400**

Choice of Plus or Minus Tol..... **Minus**

.400" Minus Single End Assembly would be ordered as Product Group 225B, Price Range 4, Size .400" Minus

Metric GO/NOGO Gages with Handle



Price Range	Diameter Range (mm)	Class Z GO		Class X GO		Class XX GO	
		Class Z GO/NOGO Ass'y. (240E)	Assembly <i>or</i> NOGO Ass'y. (245F)	Class X GO/NOGO Ass'y. (250G)	Assembly <i>or</i> NOGO Ass'y. (255H)	Class XX GO/NOGO Ass'y. (256K)	Assembly <i>or</i> NOGO Ass'y. (257L)
1	0.22mm to 1.90mm	\$ 22.84	\$ 14.33	\$ 50.48	\$ 27.92	\$ 100.97	\$ 55.81
2	1.91mm to 4.56mm	22.84	14.33	43.92	24.63	87.83	49.25
3	4.57mm to 7.14mm	23.26	14.77	44.33	25.04	88.65	50.06
4	7.15mm to 10.32mm	24.63	15.68	45.55	25.85	91.12	51.72
5	10.33mm to 12.70mm	28.20	17.91	48.85	27.92	97.68	55.81
6	12.71mm to 12.96mm	30.53	19.08	61.96	34.48	123.95	68.94
7	12.97mm to 15.30mm	36.82	24.45	67.71	39.40	135.43	78.80
8	15.31mm to 16.20mm	43.25	27.67	67.71	39.40	135.43	78.80
9	16.21mm to 19.30mm	49.08	29.46	69.77	41.06	139.56	82.09
10	19.31mm to 20.36mm	58.83	39.31	80.72	46.42	160.87	92.84
11	20.37mm to 22.04mm	62.41	41.11	89.39	53.77	178.75	107.53
12	22.05mm to 23.72mm	65.99	42.88	89.39	53.77	178.75	107.53
13	23.73mm to 25.41mm	69.56	44.69	89.39	53.77	178.75	107.53

One complete GO/NOGO gage includes: one Plus member (GO), one Minus member (NOGO), one Double End Handle with Bushings assembled.

GO gage includes: one Plus member with Single End Handle and Bushing assembled.

NOGO gage includes: one Minus member with Single End Handle and Bushing assembled.

GO/NOGO gages are available with special diameter or length gages, prices on request.

Gage Handles marked with size and direction of tolerance. *Additional markings \$0.50 per character.



Black Oxide Coated Class ZZ GO/NOGO Gages

Black OX from Meyer Gage

Gage pins with a durable protective black oxide coating.

Example of how to order: 216B 4 .3250+

Black OX is a division of Meyer Gage



Features Include:

- Black Oxide treatment
- Class ZZ .0002" tolerance –gages clearly marked
- No sharp edges
- All gages 2" long
- Available in 0.001" increments
- Certificate of conformance to ANSIB89.1.5-1998

Uses:

- Measuring hole size and depth-checking locations
- GO & NOGO gaging
- Inspect holes, or slots for pass/fail conditions
- Check micrometers and calipers

Finish

- Black OX surface treatment
- Centerless ground
- 10 micro-inch finish
- Heat treated to 60-62 Rockwell C
- Each gage with .0002" limit
- Roundness Geometry .0001" limit

Class ZZ

Price Range	Description	GO/NOGO Ass'y. (215A)	GO or NOGO Ass'y. (216B)
1	0.0110" to 0.075"	\$17.96	\$11.97
2	0.0760" to 0.180"	\$17.42	\$11.82
3	0.1810" to 0.281"	\$19.21	\$12.25
4	0.2820" to 0.406"	\$19.90	\$13.07
5	0.4070" to 0.500"	\$23.23	\$15.14
6	0.5010" to 0.510"	\$24.85	\$15.95
7	0.5110" to 0.625"	\$30.65	\$20.92
8	0.6260" to 0.635"	\$33.89	\$22.54
9	0.6360" to 0.750"	\$35.96	\$24.20

One complete GO/NOGO gage includes:

- one Plus member (GO)
- one Minus member (NOGO)
- one Double End Handle with Bushings assembled

GO gage includes:

- one Plus member with Single End Handle and Bushing assembled

NOGO gage includes:

- one Minus member with Single End Handle and Bushing assembled

Gage Handles marked with size and direction of tolerance.

*Additional markings \$0.50 per character.



Gage Handles & Accessories

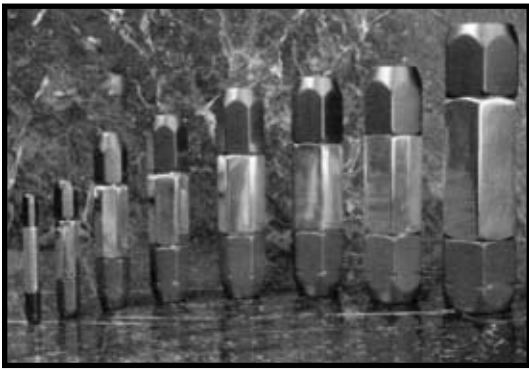

Handles furnished without bushings. Bushings sold separately (see below). Custom engraving available at \$.50 per character.

Plug Gage Diameter (mm)	Double End		Single End	
	Handle #	Price	Handle #	Price
0.005" to 0.075" (0.13 to 1.89)	1WDE	\$6.04	1WSE	\$ 5.65
0.076" to 0.180" (1.90 to 4.57)	2WDE	\$6.86	2WSE	6.04
0.181" to 0.281" (4.58 to 7.13)	3WDE	\$7.26	3WSE	6.46
0.282" to 0.406" (7.14 to 10.31)	4WDE	\$8.46	4WSE	7.26
0.407" to 0.510" (10.32 to 12.95)	5WDE	\$11.68	5WSE	9.27
0.511" to 0.635" (12.96 to 16.12)	6WDE	\$14.91	6WSE	12.90
0.636" to 0.760" (16.13 to 19.30)	7WDE	\$16.93	7WSE	14.51
0.761" to 1.010" (19.31 to 25.41)	8WDE	\$25.72	8WSE	21.77

English Wire type, Cylindrical Gage Bushings

1W010 thru 5W510 \$2.94 each
6W532 thru 8W1.00 \$4.20 each

MATERIAL
1W thru 5W BRASS
6W thru 8W ALUMINUM

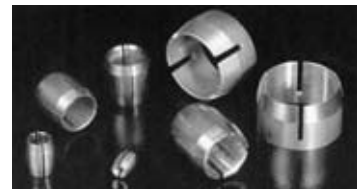

Range			Range			Range			Range		
Bushing#	Above	Thru	Bushing#	Above	Thru	Bushing#	Above	Thru	Bushing#	Above	Thru
1W010	.005	.010	2W131	.124	.131	4W301	.291	.301	6W579	.563	.579
1W015	.010	.015	2W138	.131	.138	4W311	.301	.311	6W594	.579	.594
1W020	.015	.020	2W145	.138	.145	4W321	.311	.321	6W610	.594	.610
1W025	.020	.025	2W152	.145	.152	4W331	.321	.331	6W625	.610	.625
1W030	.025	.030	2W159	.152	.159	4W341	.331	.341	6W635	.625	.635
1W035	.030	.035	2W166	.159	.166	4W351	.341	.351	7W656	.635	.656
1W040	.035	.040	2W173	.166	.173	4W361	.351	.361	7W672	.656	.672
1W045	.040	.045	2W180	.173	.180	4W371	.361	.371	7W688	.672	.688
1W050	.045	.050	3W188	.180	.188	4W382	.371	.382	7W704	.688	.704
1W055	.050	.055	3W196	.188	.196	4W394	.382	.394	7W719	.704	.719
1W060	.055	.060	3W204	.196	.204	4W406	.394	.406	7W735	.719	.735
1W065	.060	.065	3W212	.204	.212	5W420	.406	.420	7W750	.735	.750
1W070	.065	.070	3W220	.212	.220	5W435	.420	.435	7W760	.750	.760
1W075	.070	.075	3W228	.220	.228	5W450	.435	.450	8W781	.760	.781
2W082	.075	.082	3W236	.228	.236	5W465	.450	.465	8W812	.781	.812
2W089	.082	.089	3W244	.236	.244	5W480	.465	.480	8W843	.812	.843
2W096	.089	.096	3W252	.244	.252	5W495	.480	.495	8W875	.843	.875
2W103	.096	.103	3W261	.252	.261	5W510	.495	.510	8W906	.875	.906
2W110	.103	.110	3W271	.261	.271	6W532	.510	.532	8W937	.906	.937
2W117	.110	.117	3W281	.271	.281	6W547	.532	.547	8W968	.937	.968
2W124	.117	.124	4W291	.281	.291	6W563	.547	.563	8W1.000	.968	1.010

Lightweight Universal Handles (No Bushings Required)



Handle No.	Price	Range (inch)	Range (mm)
1PGHDE	\$18.80	.0110" - .0605"	(.28mm - 1.51mm)
2PGHDE	\$20.13	.0610" - .2505"	(1.52mm - 7.71mm)
3PGHDE	\$22.20	.2510" - .5005"	(7.72mm - 12.71mm)
4PGHDE	\$23.65	.5010" - .6255"	(12.72mm - 15.31mm)
5PGHDE	\$27.05	.6260" - .7505"	(15.32mm - 17.81mm)
6PGHDE	\$36.39	.7510" - .8325"	(17.82mm - 20.37mm)
7PGHDE	\$37.60	.8330" - 1.0150"	(20.38mm - 25.41mm)
8PGHDE	\$158.94	Bundle Deal	Buy all 7 handles



English Class Z Gage Sets

Meyer Gage

Class Z Pin Sets

We started making the original ZZ back in 1965 and our competition has tried, but can't copy the quality of these affordable pin gage sets. We now have taken the extra step for the better pin gage, Class Z.

Introducing the MEYER Z. A closer tolerance (0.0001), more accurate, and better for your needs. (See top right corner of page for details.) We have done it again. We've made a better pin gage that no other has attempted with the same great features listed below.

FEATURES:

MORE FEATURES THAN GAGES COSTING TWICE THE PRICE.

- All gages and sets are traceable to N.I.S.T.
- Boxes and gages both marked
- Size and serial number laser etched on each piece (M-0 not etched)
- Material: 52100 Bearing Steel
- No sharp edges
- All members 2" long

USES:

- Checking locations
- Measuring hole sizes and depth
- GO & NOGO gaging
- Setting micrometers
- Checking distances between holes

Finish:

- Centerless lapped
- Each gage is inspected and has a 8 microfinish or better
- Heat treated to a hardness of 60-62 Rockwell C
- All English gages with 0.0001" limit



Here is a comparison of Class ZZ and the Class Z gage pin specifications.

	OLD Class ZZ	NEW Class Z
Size deviation:	0.0002"	0.0001"
Roundness geometry:	0.0001"	0.00005"
Surface finish:	10 micro	8 micro

The Meyer Gage Class Z gage pin will meet or exceed the requirements of Class ZZ, and can replace the Class ZZ in any situation or application.

Gage Set No.	Gage - Size	Pieces	Wt/Lbs.	Price	*Cal.Report
M0M - minus	0.0110" to 0.0600"	50	1	\$ 85.09	\$ 74.00
M0P - plus	0.0110" to 0.0600"	50	1	85.09	74.00
M05M - minus	0.0115" to 0.0605"	50	1	85.09	74.00
M05P - plus	0.0115" to 0.0605"	50	1	85.09	74.00
C10M - minus	0.0110" to 0.2500"	240	8	262.36	355.20
C10P - plus	0.0110" to 0.2500"	240	8	262.36	355.20
C105M - minus	0.0115" to 0.2505"	240	8	262.36	355.20
C105P - plus	0.0115" to 0.2505"	240	8	262.36	355.20
M1M - minus	0.0610" to 0.2500"	190	8	191.46	281.20
M1P - plus	0.0610" to 0.2500"	190	8	191.46	281.20
M15M - minus	0.0615" to 0.2505"	190	8	191.46	281.20
M15P - plus	0.0615" to 0.2505"	190	8	191.46	281.20
M2M - minus	0.2510" to 0.5000"	250	23	283.63	370.00
M2P - plus	0.2510" to 0.5000"	250	23	283.63	370.00
M25M - minus	0.2515" to 0.5005"	250	23	283.63	370.00
M25P - plus	0.2515" to 0.5005"	250	23	283.63	370.00
M3M - minus	0.5010" to 0.6250"	125	24	333.28	185.00
M3P - plus	0.5010" to 0.6250"	125	24	333.28	185.00
M35M - minus	0.5015" to 0.6255"	125	24	333.28	185.00
M35P - plus	0.5015" to 0.6255"	125	24	333.28	185.00
M4M - minus	0.6260" to 0.7500"	125	33	368.72	185.00
M4P - plus	0.6260" to 0.7500"	125	33	368.72	185.00
M45M - minus	0.6265" to 0.7505"	125	33	368.72	185.00
M45P - plus	0.6265" to 0.7505"	125	33	368.72	185.00
M5M - minus	0.7510" to 0.8320"	82	29	626.24	121.36
M5P - plus	0.7510" to 0.8320"	82	29	626.24	121.36
M55M - minus	0.7515" to 0.8325"	82	29	626.24	121.36
M55P - plus	0.7515" to 0.8325"	82	29	626.24	121.36
M6M - minus	0.8330" to 0.9160"	84	35	730.60	124.32
M6P - plus	0.8330" to 0.9160"	84	35	730.60	124.32
M65M - minus	0.8335" to 0.9165"	84	35	730.60	124.32
M65P - plus	0.8335" to 0.9165"	84	35	730.60	124.32
M7M - minus	0.9170" to 1.0000"	84	41	765.40	124.32
M7P - plus	0.9170" to 1.0000"	84	41	765.40	124.32
M75M - minus	0.9175" to 1.0005"	84	41	765.40	124.32
M75P - plus	0.9175" to 1.0005"	84	41	765.40	124.32

(*) Calibration report for all components is an option, and priced in addition to set price.



English Class Z Library Sets

Z Model No.	Wt. (lbs)	Size Range	Number of members	Price	*Cal.Report
LS - minus	87	0.011" to 0.625"	(615 gages)	\$1,062.65	\$910.20
LS - plus	87	0.011" to 0.625"	(615 gages)	1,062.65	910.20
LC - minus	120	0.011" to 0.750"	(740 gages)	1,539.16	1,095.20
LC - plus	120	0.011" to 0.750"	(740 gages)	1,539.16	1,095.20
L1 - minus	120	0.061" to 0.750"	(690 gages)	1,469.57	1,021.20
L1 - plus	120	0.061" to 0.750"	(690 gages)	1,469.57	1,021.20
L2C - minus	96	0.011" to 0.5005"	(980 gages in .0005" increments)	1,386.07	1,450.40
L2C - plus	96	0.011" to 0.5005"	(980 gages in .0005" increments)	1,386.07	1,450.40
L2 - minus	95	0.061" to 0.5005"	(880 gages in .0005" increments)	1,246.91	1,302.40
L2 - plus	95	0.061" to 0.5005"	(880 gages in .0005" increments)	1,246.91	1,302.40
L3 - minus	240	0.061" to 1.000"	(940 gages)	3,746.28	1,391.20
L3 - plus	240	0.061" to 1.000"	(940 gages)	3,746.28	1,391.20
L4 - minus	240	0.011" to 1.000"	(990 gages)	3,815.86	1,465.20
L4 - plus	240	0.011" to 1.000"	(990 gages)	3,815.86	1,465.20
L5 - minus	140	0.751" to 1.000"	(250 gages)	2,450.67	370.00
L5 - plus	140	0.751" to 1.000"	(250 gages)	2,450.67	370.00

(**) Consists of (2) four - drawer cabinets

(*) Calibration report for all components is an option, and priced in addition to set price.



Class ZZ Black OX Gage Sets

Black OX from Meyer Gage
Gage pins with a durable protective black oxide coating.

Black OX is a division of Meyer Gage

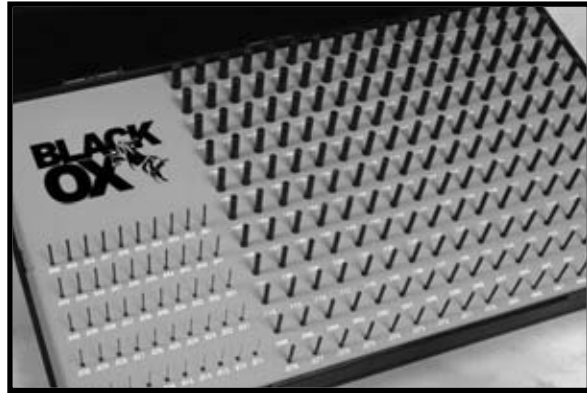

Features Include:

- Black Oxide treatment
- Class ZZ 0.061" and larger –gage clearly marked
- No sharp edges
- All gages 2" long
- All pins or sets available in 0.001" increments
- Certificate of conformance to ANSIB89.1.5-1998

Uses:

- Measuring hole size and depth-checking locations
- GO & NOGO gaging
- Inspect holes, or slots for pass/fail conditions
- Check micrometers and calipers

Finish:

- Black OX surface treatment
- Centerless ground
- 10 micro-inch finish
- Heat treated to 60-62 Rockwell C
- Each gage with 0.0002" limit

P/N	Description	Price
B0M -minus	.011" - .060"	\$69.00
B0P -plus	.011" - .060"	\$69.00
B10M -minus	.011" - .250"	\$218.50
B10P -plus	.011" - .250"	\$218.50
B1M -minus	.061" - .250"	\$154.10
B1P -plus	.061" - .250"	\$154.10
B2M -minus	.251" - .500"	\$230.00
B2P -plus	.251" - .500"	\$230.00
B3M -minus	.501" - .625"	\$270.25
B3P -plus	.501" - .625"	\$270.25
B4M -minus	.626" - .750"	\$299.00
B4P -plus	.626" - .750"	\$299.00



Replacement Pins

Description	Price
.011" to .060"	\$2.88
.061" to .500"	\$2.59
.501" to .625"	\$3.45
.626" to .750"	\$5.18

IMPORTANT: Specify plus or minus on replacement pins



Class ZZ Black OX Library Sets

Library Series of Pins with Heavy Duty Tool Chest

P/N	Description	Price
BSM -minus	.011" to .625"	\$969.61
BSP -plus	.011" to .625"	\$969.61
BCM -minus	.011" to .750"	\$1,269.08
BCP -plus	.011" to .750"	\$1,269.08
BAM -minus	.061" to .750"	\$1,201.46
BAP -plus	.061" to .750"	\$1,201.46

Features Include:

- Black Oxide treatment
- Class ZZ 0.061" and larger –gages clearly marked
- No sharp edges
- All gages 2" long
- All pins or sets available in 0.001" increments
- Certificate of conformance to ANSIB89.1.5-1998

Uses:

- Measuring hole size and depth-checking locations
- GO & NOGO gaging
- Inspect holes or slots for pass/fail conditions
- Check micrometers and calipers

Finish:

- Black OX surface treatment
- Centerless ground
- 10 micro-inch finish
- Heat treated to 60-62 Rockwell C
- Each gage with 0.0002" limit
- Roundness geometry 0.0001" limit

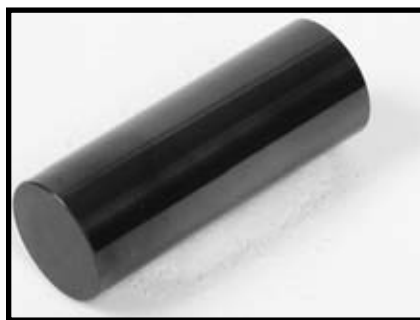

Metric Z Gage Sets

Class Z

Just look at this selection of Metric gage pin sets. If we don't make it, you probably don't need it! These sets have all the features of our English sets, but provide the finer increments in size that you just can't get by converting English to Metric.

Meyer Gage Class Z Pin Sets

FEATURES:

MORE FEATURES THAN GAGES COSTING TWICE THE PRICE.

- All gages and sets are traceable to N.I.S.T.
- Boxes and gages both marked
- Size and serial number laser etched on each piece (M-0 not etched)
- Material: 52100 Bearing Steel
- No sharp edges
- 51mm overall length
- All sets in .02mm increments

USES:

- Checking locations
- Measuring hole sizes and depth
- GO & NOGO gaging
- Setting micrometers
- Checking distances between holes

FINISH:

- Centerless lapped
- Each gage is inspected and has a 8 microfinish or better
- Heat treated to a hardness of 60-62 Rockwell C
- All metric gages with .0025mm tolerance limit



Gage Set No.	Gage - Size	Pieces	Wt/Lbs.	Price	*Cal.Report
M0MMM - minus	.22 to 1.50	65	1	\$ 110.62	\$ 96.20
M0MMP - plus	.22 to 1.50	65	1	110.62	96.20
M01MMM - minus	.23 to 1.51	65	1	110.62	96.20
M01MMP - plus	.23 to 1.51	65	1	110.62	96.20
M1MMM - minus	1.52 to 7.70	310	10	389.99	458.80
M1MMP - plus	1.52 to 7.70	310	10	389.99	458.80
M11MMM - minus	1.53 to 7.71	310	10	389.99	458.80
M11MMP - plus	1.53 to 7.71	310	10	389.99	458.80
M2MMM - minus	7.72 to 12.70	250	25	419.78	370.00
M2MMP - plus	7.72 to 12.70	250	25	419.78	370.00
M21MMM - minus	7.73 to 12.71	250	25	419.78	370.00
M21MMP - plus	7.73 to 12.71	250	25	419.78	370.00
M3MMM - minus	12.72 to 15.30	130	24	465.16	192.40
M3MMP - plus	12.72 to 15.30	130	24	465.16	192.40
M31MMM - minus	12.73 to 15.31	130	24	465.16	192.40
M31MMP - plus	12.73 to 15.31	130	24	465.16	192.40
M4MMM - minus	15.32 to 17.80	125	30	493.52	185.00
M4MMP - plus	15.32 to 17.80	125	30	493.52	185.00
M41MMM - minus	15.33 to 17.81	125	30	493.52	185.00
M41MMP - plus	15.33 to 17.81	125	30	493.52	185.00
M5MMM - minus	17.82 to 20.36	128	38	585.88	189.44
M5MMP - plus	17.82 to 20.36	128	38	585.88	189.44
M51MMM - minus	17.83 to 20.37	128	38	585.88	189.44
M51MMP - plus	17.83 to 20.37	128	38	585.88	189.44
M6MMM - minus	20.38 to 22.04	84	32	701.39	124.32
M6MMP - plus	20.38 to 22.04	84	32	701.39	124.32
M61MMM - minus	20.39 to 22.05	84	32	701.39	124.32
M61MMP - plus	20.39 to 22.05	84	32	701.39	124.32
M7MMM - minus	22.06 to 23.72	84	37	809.94	124.32
M7MMP - plus	22.06 to 23.72	84	37	809.94	124.32
M71MMM - minus	22.07 to 23.73	84	37	809.94	124.32
M71MMP - plus	22.07 to 23.73	84	37	809.94	124.32
M8MMM - minus	23.74 to 25.40	84	41	832.20	124.32
M8MMP - plus	23.74 to 25.40	84	41	832.20	124.32
M81MMM - minus	23.75 to 25.41	84	41	832.20	124.32
M81MMP - plus	23.75 to 25.41	84	41	832.20	124.32

(*) – Calibration report for all components is an option, and priced in addition to set price.



Metric Z Library Sets

.0025 METRIC LIBRARY SERIES

Model No.	Wt. (lbs)	Size Range	Number of members	Price	*Cal.Report
L10MM - minus	124	1.52mm to 17.80mm	(815 gages)	\$2,049.88	\$1,206.20
L10MM - plus	124	1.52mm to 17.80mm	(815 gages)	2,049.88	\$1,206.20
L11MM - minus	124	1.53mm to 17.81mm	(815 gages)	2,049.88	\$1,206.20
L11MM - plus	124	1.53mm to 17.81mm	(815 gages)	2,049.88	\$1,206.20
L20MM - minus	183	17.82mm to 25.40mm	(380 gages)	3,243.91	\$ 562.40
L20MM - plus	183	17.82mm to 25.40mm	(380 gages)	3,243.91	\$ 562.40
L21MM - minus	183	17.83mm to 25.41mm	(380 gages)	3,243.91	\$ 562.40
L21MM - plus	183	17.83mm to 25.41mm	(380 gages)	3,243.91	\$ 562.40
**L30MM - minus	305	1.52mm to 25.40mm	(1195 gages)	5,293.76	\$1,768.60
**L30MM - plus	305	1.52mm to 25.40mm	(1195 gages)	5,293.76	\$1,768.60
**L31MM - minus	305	1.53mm to 25.41mm	(1195 gages)	5,293.76	\$1,768.60
**L31MM - plus	305	1.53mm to 25.41mm	(1195 gages)	5,293.76	\$1,768.60

(**) consists of (2) four-drawer cabinets

(*) Calibration report for all components is an option, and priced in addition to set price.

IMPORTANT: Specify **PLUS** or **MINUS** when ordering individual members.

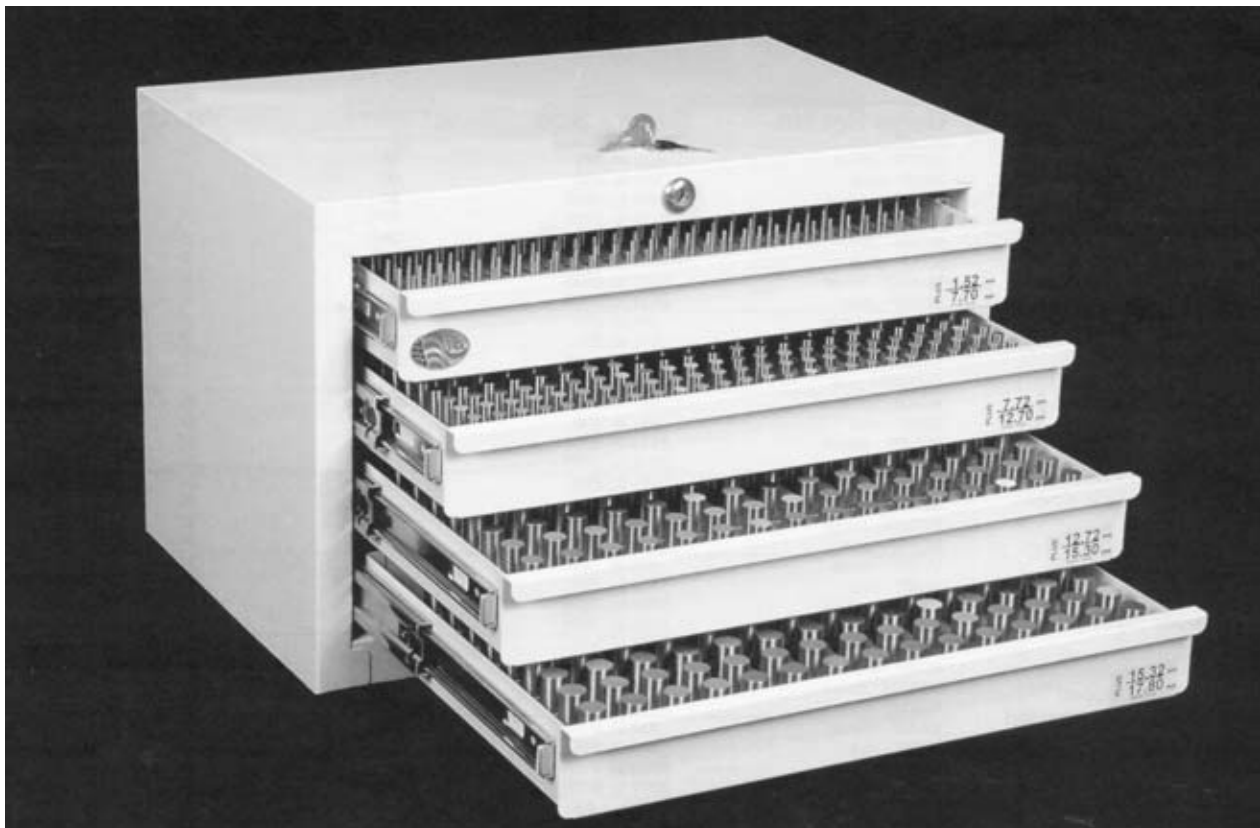

(*) Calibration report for all components is an option, and priced in addition to set price.



Class X Gage Sets



Offers the same “features” as our Class Z pin gages, but with 0.00004” tolerance limits and 0.00002” roundness limits. The pins are perfect for critical inspection needs, or when you want to maximize your GO/ NOGO tolerance limits. They’re also a great way to calibrate measuring equipment, micrometers, and calipers.

FEATURES:

- All gages and sets are traceable to N.I.S.T.
- Boxes and gages both marked
- Size and serial number laser etched on each piece (M0X not etched)
- Material: 52100 Bearing Steel
- No sharp edges
- All members 2” long

USES:

- Checking locations
- Measuring hole sizes and depth
- GO & NOGO gaging
- Setting micrometers
- Checking distances between holes

Finish:

- Centerless lapped
- Each gage is inspected and has a 2 microfinish or better
- Heat treated to a hardness of 60-62 Rockwell C
- All English gages with 0.00004” limit

Gage Set No.	Gage - Size	Pieces	Wt/Lbs.	Price *Cal.Report
M0XM - minus	.011 to .060	50	1	\$ 454.31 \$588.50
M0XP - plus	.011 to .060	50	1	454.31 \$588.50
M05XM - minus	.0115 to .0605	50	1	454.31 \$588.50
M05XP - plus	.0115 to .0605	50	1	454.31 \$588.50
M1XM - minus	.061 to .250	190	7	1,193.84 \$ 2,236.30
M1XP - plus	.061 to .250	190	7	1,193.84 \$ 2,236.30
M15XM - minus	.0615 to .2505	190	7	1,193.84 \$ 2,236.30
M15XP - plus	.0615 to .2505	190	7	1,193.84 \$ 2,236.30
C10XM - minus	.011 to .250	240	8	1,579.15 \$ 2,824.80
C10XP - plus	.011 to .250	240	8	1,579.15 \$ 2,824.80
C105XM - minus	.0115 to .2505	240	8	1,579.15 \$ 2,824.80
C105XP - plus	.0115 to .2505	240	8	1,579.15 \$ 2,824.80
M2XM - minus	.251 to .500	250	23	1,579.15 \$ 2,942.50
M2XP - plus	.251 to .500	250	23	1,579.15 \$ 2,942.50
M25XM - minus	.2515 to .5005	250	23	1,579.15 \$ 2,942.50
M25XP - plus	.2515 to .5005	250	23	1,579.15 \$ 2,942.50
M3XM - minus	.501 to .625	125	24	1,341.06 \$ 1,471.25
M3XP - plus	.501 to .625	125	24	1,341.06 \$ 1,471.25
M35XM - minus	.5015 to .6255	125	24	1,341.06 \$ 1,471.25
M35XP - plus	.5015 to .6255	125	24	1,341.06 \$ 1,471.25
M4XM - minus	.626 to .750	125	33	1,421.23 \$ 1,471.25
M4XP - plus	.626 to .750	125	33	1,421.23 \$ 1,471.25
M45XM - minus	.6265 to .7505	125	33	1,421.23 \$ 1,471.25
M45XP - plus	.6265 to .7505	125	33	1,421.23 \$ 1,471.25
M5XM - minus	.751 to .832	82	29	1,194.08 \$965.14
M5XP - plus	.751 to .832	82	29	1,194.08 \$965.14
M55XM - minus	.7515 to .8325	82	29	1,194.08 \$965.14
M55XP - plus	.7515 to .8325	82	29	1,194.08 \$965.14
M6XM - minus	.833 to .916	84	35	1,257.24 \$988.68
M6XP - plus	.833 to .916	84	35	1,257.24 \$988.68
M65XM - minus	.8335 to .9165	84	35	1,257.24 \$988.68
M65XP - plus	.8335 to .9165	84	35	1,257.24 \$988.68
M7XM - minus	.917 to 1.000	84	41	1,441.88 \$988.68
M7XP - plus	.917 to 1.000	84	41	1,441.88 \$988.68
M75XM - minus	.9175 to 1.0005	84	41	1,441.88 \$988.68
M75XP - plus	.9175 to 1.0005	84	41	1,441.88 \$988.68

(*) Calibration report for all components is an option, and priced in addition to set price.



Class X Library Sets

0.00004" CLASS X LIBRARY SERIES

Z Model No.	Wt. (lbs)	Size Range	Number of members	Price	*Cal.Report
LCX - minus	120	.011" to .750"	(740 gages)	\$5,920.59	\$8,709.80
LCX - plus	120	.011" to .750"	(740 gages)	5,920.59	8,709.80
L1X - minus	120	.061" to .750"	(690 gages)	5,490.57	8,121.30
L1X - plus	120	.061" to .750"	(690 gages)	5,490.57	8,121.30
L2CX - minus	96	.011" to .5005"	(980 gages in .0005" increments)	6,170.82	11,534.60
L2CX - plus	96	.011" to .5005"	(980 gages in .0005" increments)	6,170.82	11,534.60
L2X - minus	95	.061" to .5005"	(880 gages in .0005" increments)	5,397.04	10,357.60
L2X - plus	95	.061" to .5005"	(880 gages in .0005" increments)	5,397.04	10,357.60
**L3X - minus	240	.061" to 1.000"	(940 gages)	9,275.66	11,063.80
**L3X - plus	240	.061" to 1.000"	(940 gages)	9,275.66	11,063.80
**L4X - minus	240	.011" to 1.000"	(990 gages)	9,642.51	11,652.30
**L4X - plus	240	.011" to 1.000"	(990 gages)	9,642.51	11,652.30

(**)Consists of (2) four-drawer cabinets

(*) Calibration report for all components in set is an option, and priced in addition to set price.



Class X MG-25 Series

Used as masters to calibrate measuring equipment and check linearity of comparators, micrometers, and calipers. These "Tenth Step" gage sets have unlimited applications, such as quality control inspection, prototype work and production layout. Inspectors select from the range of pins to find the size of a hole or slot. These round masters simulate a cylindrical part which, unlike flat blocks, can detect uneven wear on the tips of micrometers and calipers. The thin "line" of contact detects uneven face wear better than flat gage blocks with large contact area.

Features:

- Each set contains 25 pieces of Class X tolerance (.00004") gage pins. Traceable to NIST
- Choice of two tolerances: Plus (+.00004") or Minus (-.00004")
- Sets consist of a center nominal size, and 12 gages larger in .0001" steps and 12 gages smaller in .0001" steps. Metric sets available in 0.01mm increments.
- Each gage is inspected and has a 2 microfinish or better.
- Heat treated and through hardened to 60-62 Rockwell C
- All pin gages over .060" or 1.51 mm are laser marked with size direction of tolerance and serial number for traceability.

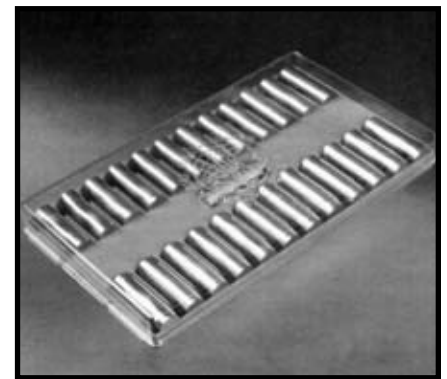

GAGE SET NO.	NOMINAL SIZE RANGE		SET PRICE
	<i>English</i>	<i>or</i> <i>Metric</i>	
MG1-25	.0122" to .0609"	0.28mm to 1.54mm	\$374.10
MG2-25	.0610" to .2509"	1.55mm to 6.37mm	186.11
MG3-25	.2510" to .5009"	6.38mm to 12.72mm	214.55
MG4-25	.5010" to .7499"	12.73mm to 19.04mm	296.09
MG5-25	.7500" to .8129"	19.05mm to 20.64mm	414.55

(*) Calibration report for all components is an option, and priced in addition to set price.



Custom Length

Class ZZ Gages

Reversible pin gages up to 12" lengths. These are invaluable when you need to gage deep or hard to reach holes or slots.

- Centerless ground to a 10 microfinish or better
- Made from HSS Steel or E52100
- Plus, Minus or Bilateral tolerance
- NIST Traceable
- Stabilized and heat treated to 60-62RC

Diameter Range		2.5"	3"	4"	5"	6"	9"	12"
0.0110" to 0.0629"	0.279mm to 1.575mm	\$45.75	\$46.96	\$47.89	\$50.03	\$52.71	\$54.84	\$79.60
0.0630" to 0.1879"	1.576mm to 4.750mm	45.62	45.75	45.89	47.49	49.76	53.65	80.80
0.1880" to 0.2509"	4.751mm to 6.350mm	46.29	46.69	46.55	47.89	50.44	56.99	83.08
0.2510" to 0.3129"	6.351mm to 7.925mm	48.15	48.30	48.57	48.70	50.70	60.07	86.68
0.3130" to 0.3759"	7.926mm to 9.525mm	49.90	50.03	50.17	50.30	53.65	65.55	94.86
0.3760" to 0.4389"	9.526mm to 11.125mm	56.99	57.26	57.39	57.52	57.66	69.71	101.81
0.4390" to 0.5009"	11.126mm to 12.700mm	54.98	64.21	64.21	62.07	57.26	74.91	106.63
0.5010" to 0.5319"	12.701mm to 13.487mm	56.86	63.68	63.68	65.81	60.07	73.85	104.88
0.5320" to 0.5639"	13.488mm to 14.300mm	57.79	65.15	65.15	67.69	62.07	76.93	108.35
0.5640" to 0.5949"	14.301mm to 15.088mm	58.74	66.62	66.62	69.57	63.95	79.73	113.32
0.5950" to 0.6259"	15.089mm to 15.875mm	59.67	68.22	68.22	71.44	65.81	82.94	117.06
0.6260" to 0.6569"	15.876mm to 16.662mm	60.73	70.51	70.51	73.72	73.72	87.48	122.53
0.6570" to 0.6879"	16.663mm to 17.450mm	61.67	72.11	72.11	75.45	75.45	90.58	127.36
0.6880" to 0.7189"	17.451mm to 18.237mm	63.14	73.85	73.85	78.26	78.26	94.06	132.44
0.7190" to 0.7509"	18.238mm to 19.050mm	63.82	75.18	75.18	79.73	79.73	96.85	134.31
0.7510" to 0.7819"	19.051mm to 19.837mm	65.15	76.40	76.40	82.28	82.28	99.26	137.53
0.7820" to 0.8129"	19.838mm to 20.625mm	66.50	78.00	78.00	84.95	84.95	102.35	142.60
0.8130" to 0.8439"	20.626mm to 21.412mm	67.30	79.33	79.33	86.68	86.68	105.14	147.02
0.8440" to 0.8759"	21.413mm to 22.225mm	68.49	81.34	81.34	89.23	89.23	109.04	151.03
0.8760" to 0.9069"	22.226mm to 23.012mm	69.44	83.20	83.20	90.96	90.96	112.78	158.52
0.9070" to 0.9379"	23.013mm to 23.800mm	70.77	84.95	84.95	93.51	93.51	116.39	162.81
0.9380" to 0.9689"	23.801mm to 24.587mm	71.97	86.68	86.68	95.92	95.92	119.87	168.16
0.9690" to 1.0009"	24.588mm to 25.400mm	73.58	89.09	89.09	99.13	99.13	124.82	174.58

No guarantee of straightness due to Centerless Grinding process on these products. Class ZZ custom length gages are not returnable for credit or cancellation.



Class X Gages

Reversible pin gages in English and Metric up to 6" lengths. Ideal for deep and hard to reach holes or slots.

- Centerless lapped to a 5 microfinish
- Up to 6" long
- NIST Traceable
- Stabilized and heat treated to 60-62 RC
- Plus, Minus or Bilateral tolerance

Custom Lengths

OVERALL LENGTH 3" inches

Inch Size	Millimeter Size	Price
.0100" to .0299"	.254mm to .759mm	\$ 163.43
.0300" to .0599"	.762mm to 1.52mm	87.90
.0600" to .2009"	1.52mm to 5.10mm	59.89
.2010" to .3749"	5.11mm to 9.52mm	62.97
.3750" to .6349"	9.53mm to 16.13mm	67.14
.6350" to .7500"	16.13mm to 19.05mm	67.14
.7501" to .8750"	19.05mm to 22.23mm	117.86
.8751" to 1.000"	22.23mm to 25.40mm	132.14

OVERALL LENGTH 5" inches

Inch Size	Millimeter Size	Price
.0100" to .0299"	.254mm to .759mm	\$ 407.06
.0300" to .0599"	.762mm to 1.52mm	218.31
.0600" to .2009"	1.52mm to 5.10mm	113.02
.2010" to .3749"	5.11mm to 9.52mm	115.92
.3750" to .6349"	9.53mm to 16.13mm	121.72
.6350" to .7500"	16.13mm to 19.05mm	131.37
.7501" to .8750"	19.05mm to 22.23mm	209.23
.8751" to 1.000"	22.23mm to 25.40mm	240.53

OVERALL LENGTH 4" inches

Inch Size	Millimeter Size	Price
.0100" to .0299"	.254mm to .759mm	\$ 223.44
.0300" to .0599"	.762mm to 1.52mm	119.77
.0600" to .2009"	1.52mm to 5.10mm	82.13
.2010" to .3749"	5.11mm to 9.52mm	83.66
.3750" to .6349"	9.53mm to 16.13mm	88.68
.6350" to .7500"	16.13mm to 19.05mm	91.27
.7501" to .8750"	19.05mm to 22.23mm	157.63
.8751" to 1.000"	22.23mm to 25.40mm	173.31

OVERALL LENGTH 6" inches

Inch Size	Millimeter Size	Price
.0100" to .0299"	.254mm to .759mm	\$ 526.73
.0300" to .0599"	.762mm to 1.52mm	293.34
.0600" to .2009"	1.52mm to 5.10mm	129.35
.2010" to .3749"	5.11mm to 9.52mm	131.29
.3750" to .6349"	9.53mm to 16.13mm	133.31
.6350" to .7500"	16.13mm to 19.05mm	144.89
.7501" to .8750"	19.05mm to 22.23mm	260.23
.8751" to .9375"	22.23mm to 23.81mm	294.23
.9376" to 1.000"	23.82mm to 25.40mm	332.48

No guarantee of straightness, due to Centerless Grinding process on these products. Class X custom length gages are not returnable for credit or cancellation.



Gage Storage Accessories

Durable Poly Cases

Poly Case for M-0 Set.....	\$16.53 each
Poly Case for M-1 thru M-8 Set.....	\$33.06 each
Poly Case with insert for M-0 Set.....	\$33.06 each
Poly Case with insert for M-1 thru M-8 Set.....	\$66.12 each

Each hole size marked on insert.

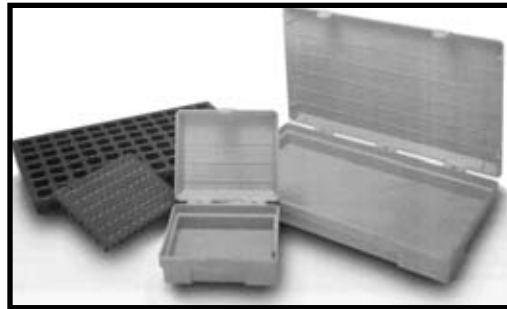

Poly Inserts

Poly Insert for M-0 Set.....	\$16.53 each
Poly Insert for M-1 thru M-8 Set.....	\$33.06 each

Each hole size marked on insert.

Heavy Duty Metal Storage Cabinets

Be sure to protect your gages from heat and moisture. After use, each gage should be wiped clean of fingerprints and contaminants, then oiled with a rust inhibitor.



We recommend Tri Flow® lubricant for gage maintenance.

6 oz Aerosol Can \$9.19



Upgrade Existing Sets

Model Number	Wt./lbs		Price
L-E4	38	four drawer cabinet, empty	\$375.00
L-IN4	38	four drawer cabinet, w/4 inserts (*)	\$459.99

* Includes four inserts of your choice. Please specify when ordering.

Ring Gages*

The Meyer Difference

- ❑ **The Material.** We use only superb quality steels such as 06, or Alloy Steels such as 8620, and Heat Treat our blanks to a minimum of 58RC.
- ❑ **The Stabilization Process.** Subsequent grinding operations can introduce heat and stress. All blanks go through a stabilization process, cycling them through temperature extremes from -130°F to +300°F.
- ❑ **The Precision Lapping Process.** "Lapping" is the finishing process that removes small amounts of material from the gage surface and brings it within its final tolerance limits.
- ❑ **Inspection with NIST-traceable gages.** In our Metrology area conditions are a strict, cool 68°F where the relative humidity is between 30 - 50% and all of our masters are traceable to NIST.



Size Range										
Inches	Millimeters	Class XX			Class X			Class Y, Z		
Above to & including	Above to & including	Chrome	Steel	Tungsten	Chrome	Steel	Tungsten	Chrome	Steel	Tungsten
.040001 - .100	1.02 - 2.54	—	\$ 221.63	\$354.11	—	\$ 199.47	\$318.71	—	\$ 177.31	\$ 283.30
.100001 - .150	2.54 - 3.81	—	192.73	321.92	—	173.45	289.73	—	154.18	257.53
.150001 - .185	3.81 - 4.70	\$ 234.63	167.59	292.66	\$ 211.16	150.83	263.39	\$ 187.70	134.07	234.12
.185001 - .230	4.70 - 5.84	223.45	159.61	284.13	201.11	143.65	255.72	178.76	127.68	227.31
.230001 - .365	5.84 - 9.27	212.81	152.00	275.86	191.53	136.81	248.27	170.25	121.61	220.69
.365001 - .510	9.27 - 12.95	202.68	144.77	267.82	182.41	130.30	241.04	162.14	115.81	214.26
.510001 - .825	12.95 - 20.96	212.81	152.00	348.17	191.53	136.81	313.35	170.25	121.61	278.54
.825001 - 1.135	20.96 - 28.83	223.45	159.61	452.62	201.11	143.65	407.35	178.76	127.68	362.09
1.135001 - 1.510	28.83 - 38.35	256.97	199.51	611.04	231.27	179.55	549.93	205.58	159.61	488.83
1.510001 - 2.010	38.35 - 51.05	295.52	229.44	824.90	265.96	206.49	742.41	236.41	183.55	659.91
2.010001 - 2.510	51.05 - 63.75	369.39	270.73	1,072.36	332.46	243.66	965.13	295.52	216.59	857.89
2.510001 - 3.010	63.75 - 76.45	461.73	319.47	1,340.45	415.57	287.52	1,206.41	369.39	255.57	1,072.36
3.010001 - 3.510	76.45 - 89.15	531.00	376.97	1,675.56	477.91	339.27	1,508.02	424.79	301.58	1,340.45
3.510001 - 4.010	89.15 - 101.85	610.64	444.82	2,094.46	549.59	400.34	1,885.03	488.52	355.86	1,675.56

- ❑ MASTER: bilateral (split) tolerance.
- ❑ GO: unilateral (one way) minus tolerance.
- ❑ NOGO: unilateral (one way) plus tolerance.

Ring Gages are manufactured in accordance with ANSI spec B89.1.6 - 1989. ROUNDNESS and TAPER of all gages will not exceed 50% of applicable gagemaker's size tolerance and are non-cumulative. *Ring gages are not returnable for credit or cancellation.



Taperlocks* Steel & Chrome

- Quick change over!
The members pop out
for quick replacement.
Excellent for larger
diameter inspection.
- NIST traceable
 - Plus, Minus or Bilateral tolerance
 - Class XX, X, Y or Z
 - Steel or Chrome



Taperlocks - Steel and Chrome

Unilateral Tolerances • GO = PLUS tolerance, NOGO = MINUS tolerance; Chrome Plates –Add 100%

Size Range	Std. GO Member Only			Std. NOGO Member Only			Handle	
	Class	Length	Price	Length	Price	No.	Price	
.1050" to .1500" 2.67mm to 3.81mm	XX		\$ 72.89		\$65.69			
	X	3/8 "	62.10	7/32 "	56.69			
	Y	9.5mm	55.15	5.6mm	50.36	00	\$16.72	
	Z		48.57		45.39			
.1501" to .2300" 3.81mm to 5.84mm	XX		69.29		62.52			
	X	13/32 "	59.01	9/32 "	56.69			
	Y	10.3mm	53.95	7.1mm	49.42	0	\$16.72	
	Z		44.11		42.31			
.2301" to .3650" 5.84mm to 9.27mm	XX		71.94		65.69			
	X	3/4 "	60.29	5/16 "	56.69			
	Y	19.1mm	55.76	7.9mm	50.36	1	\$16.72	
	Z		45.90		43.16			
.3651" to .5100" 9.27mm to 12.95mm	XX		74.68		68.34			
	X	1 "	62.95	3/8 "	58.50			
	Y	25.4mm	57.55	9.5mm	52.16	2	\$16.72	
	Z		47.71		44.97			
.5101" to .8250" 12.95mm to 20.96mm	XX		77.34		71.08			
	X	1-1/4 "	65.63	1/2 "	60.29			
	Y	31.8mm	59.36	12.7mm	53.95	3	\$16.72	
	Z		50.36		47.27			
.8251" to 1.1350" 20.96mm to 28.83mm	XX		89.07		80.08			
	X	1-1/2 "	71.94	5/8 "	65.69			
	Y	38.1mm	62.10	15.9mm	57.13	4	\$16.72	
	Z		55.76		51.31			
1.1351" to 1.5100" 28.83mm to 38.35mm	XX		93.52		83.68			
	X	1-5/8"	85.47	3/4"	77.34			
	Y	41.3mm	70.15	19.1mm	63.89	5	\$18.82	
	Z		59.36		56.69			

* Taperlocks are not returnable for credit or cancellation.





Trilocks - Steel and Chrome

Unilateral Tolerances • GO = PLUS tolerance, NOGO = MINUS tolerance; Chrome Plates –Add 100%

Size Range	Std. GO Member Only			Std. NOGO Member Only			Handle	
	Class	Length	Price	Length	Price	No.	Price	
.7601" to .9470" 19.30mm to 24.05mm	XX		\$ 89.35		\$ 80.86			
	X	1-1/4 "	75.66	3/4 "	69.58			
	Y	31.8mm	64.92	19.1mm	59.73	2-1/2	\$23.00	
	Z		54.00		50.77			
.9471" to 1.1350" 24.05mm to 28.83mm	XX		90.70		81.75			
	X	1-3/8 "	77.71	3/4 "	71.09			
	Y	34.9mm	66.71	19.1mm	61.06	3-1/2	23.00	
	Z		57.58		54.00			
1.1351" to 1.5100" 28.83mm to 38.25mm	XX		97.41		87.38			
	X	1-1/2 "	84.97	3/4 "	77.54			
	Y	38.1mm	70.47	19.1mm	64.28	4-1/2	25.09	
	Z		59.73		55.43			
1.5101" to 2.0100" 38.25mm to 51.05mm	XX		144.07		130.54			
	X	1-7/8 "	121.76	7/8 "	106.19			
	Y	47.6mm	109.41	22.2mm	95.41	5-1/2	26.61	
	Z		89.17		83.44			
2.0101" to 2.5100" 51.05mm to 63.75mm	XX		172.98		157.40			
	X	2 "	144.07	7/8 "	130.54			
	Y	50.8mm	127.49	22.2mm	111.48	6	26.61	
	Z		107.18		94.90			
2.5101" to 3.0100" 63.75mm to 76.45mm	XX		196.29		172.54			
	X	2 "	167.34	1 "	139.95			
	Y	50.8mm	144.07	25.4mm	125.44	7	26.61	
	Z		119.36		108.07			
3.0101" to 3.5100" 76.45mm to 89.15mm	XX		239.69		206.64			
	X	2"	183.28	1 "	170.57			
	Y	50.8mm	171.11	25.4mm	149.34	7	26.61	
	Z		146.65		128.57			

* Trilocks are not returnable for credit or cancellation.





Custom Progressive Gages*

When you need to check parts quickly, Progressive plug gages are the best choice. Both the GO and NOGO diameters are stepped on a single gage member. All members are securely attached to either a Trilock or Taperlock handle. All handles are marked with sizes and direction of tolerance.

- Class XX, X, Y, or Z
- NIST traceable
- GO, NOGO tolerances
- Tool Steel 58/60 Rockwell C
- Certificate of Accuracy included
- Additional marking available \$0.50 per character

Unilateral Tolerance, GO - Plus Tolerance, NOGO - Minus Tolerance; Chrome Plates: Add 100%
 * -Not returnable for credit or cancellation

AGD Progressive Member						Handle	
Size-Range	Class	Tolerance Inches	Member Length	GO Portion	NOGO Portion	No.	Price
TAPERLOCK STYLE							
.105 in. to .150 in.	XX	.00002					\$141.53
2.67 mm to 3.81 mm	X	.00004	23/32 in.	3/8 in.	7/32 in.	00	\$ 18.24
	Y	.00007	18.3 mm	9.5 mm	5.6 mm		98.45
	Z	.00010					82.05
.1501 in. to .230 in.	XX	.00002					129.21
3.81 mm to 5.84 mm	X	.00004	13/16 in.	13/32 in.	9/32 in.	0	18.24
	Y	.00007	20.6 mm	10.3 mm	7.1 mm		96.40
	Z	.00010					73.84
.2301 in. to .365 in.	XX	.00002					139.47
5.84 mm to 9.27 mm	X	.00004	13/16 in.	3/4 in.	5/16 in.	1	18.24
	Y	.00007	30.2 mm	19.1 mm	7.9 mm		98.45
	Z	.00010					77.95
.3651 in. to .510 in.	XX	.00002					147.68
9.27 mm to 12.95 mm	X	.00004	1-1/2 in.	1 in.	3/8 in.	2	18.24
	Y	.00007	38.1 mm	25.4 mm	9.5 mm		104.60
	Z	.00010					82.05
.5101 in. to .825 in.	XX	.00002					153.83
12.95 mm to 20.96 mm	X	.00004	1-7/8 in.	1-1/4 in.	1/2 in.	3	18.24
	Y	.00007	47.6 mm	31.8 mm	12.7 mm		110.77
	Z	.00010					86.16
.8251 in. to 1.135 in.	XX	.00003					180.50
20.96 mm to 28.83 mm	X	.00006	2-1/8 in.	1-3/8 in.	5/8 in.	4	18.24
	Y	.00009	54.0 mm	34.9 mm	15.9 mm		114.86
	Z	.00012					100.51
1.1351 in. to 1.510 in.	XX	.00003					194.85
28.83 mm to 38.35 mm	X	.00006	2-3/8 in.	1-1/2 in.	3/4 in.	5	20.53
	Y	.00009	60.3 mm	38.1 mm	19.1 mm		139.47
	Z	.00012					116.92
TRILOCK STYLE							
1.5101 in. to 2.010 in.	XX	.00004					289.21
38.35 mm to 51.05 mm	X	.00008	2-7/8 in.	1-7/8 in.	7/8 in.	5-1/2	25.19
	Y	.00012	73.0 mm	47.6 mm	22.2 mm		203.08
	Z	.00016					164.08
2.0101 in. to 2.510 in.	XX	.00004					363.05
51.05 mm to 63.75 mm	X	.00008	3 in.	2 in.	7/8 in.	6	26.14
	Y	.00012	76.2 mm	50.8 mm	22.2 mm		248.19
	Z	.00016					205.11
2.5101 in. to 3.010 in.	XX	.00005					394.59
63.75 mm to 76.45 mm	X	.00010	3 in.	2 in.	7/8 in.	7	28.16
	Y	.00015	76.2 mm	50.8 mm	22.2 mm		291.26
	Z	.00020					239.98
3.0101 in. to 3.510 in.	XX	.00005					490.21
76.45 mm to 89.15 mm	X	.00010	3 in.	2 in.	7/8 in.	7	28.16
	Y	.00015	76.2 mm	50.8 mm	22.2 mm		336.39
	Z	.00020					281.00
3.5101 in. to 4.010 in.	XX	.00005					593.98
89.15 mm to 101.85 mm	X	.00010	3-1/8 in.	2-1/8 in.	7/8 in.	7	29.34
	Y	.00015	79.4 mm	54.0 mm	22.2 mm		412.37
	Z	.00020					346.13
4.0101 in. to 4.510 in.	XX	.00005					673.02
101.85 mm to 114.55 mm	X	.00010	3-1/8 in.	2-1/8 in.	7/8 in.	7	29.34
	Y	.00015	79.4 mm	54.0 mm	22.2 mm		470.05
	Z	.00020					386.72



Master Setting Discs*



You can use these Master Discs to calibrate your measuring equipment. They are a must for your calibration lab and your inspection areas. Meyer's Master Discs are available in three styles and come with a Certificate of Accuracy.

- Class XX, X, or Y
- GO, NOGO, Bilateral tolerances available
- Steel 60/62 Rockwell C
- Comes complete with end grips
- Roundness is within half of tolerance

STYLE #1: Bilateral (Split) tolerance
STYLE #2: Unilateral (GO Plus NOGO Minus)
STYLE #3: Bilateral (Split) tolerance

*Note: For the range above 1.510" to and including 8.510" A.G.D. standards for style #2 call for style #3 master discs separated by an A.G.D. separator plate and linked together with a tie rod and insulators. Not returnable for credit or cancellation. Call for sizes not shown.

Size-Range	Class	Tolerance	Style #1			Style #2			Style #3		
			Length	Steel	Chrome	Length	Steel	Chrome	Length	Steel	Chrome
.1500 in. to .2300 in. 3.81 mm to 5.84 mm	XX	.00002		\$ 131.69	\$169.05		\$222.12	\$288.95		\$ 119.91	\$ 157.25
	X	.00004	7/8 in.	98.29	127.77	7/8 in.	165.11	216.23	7/16 in.	90.43	115.97
.2301 in. to .365 in. 5.84 mm to 9.27 mm	Y	.00007	22.2 mm	80.60	115.97	22.2 mm	147.42	192.64	11.1 mm	82.57	108.11
	XX	.00002		135.63	176.92		224.09	300.75		121.88	159.22
.3651 in. to .510 in. 9.27 mm to 12.95 mm	X	.00004	1 in.	100.24	131.69	1 in.	167.08	220.15	1/2 in.	92.38	119.91
	Y	.00007	25.4 mm	92.38	119.91	25.4 mm	149.39	194.60	12.7 mm	84.52	112.05
.5101 in. to .825 in. 12.95 mm to 20.96 mm	XX	.00002		137.60	178.87		226.05	292.89		125.80	165.11
	X	.00004	1 1/8 in.	102.21	133.66	1 1/8 in.	172.98	224.09	9/16 in.	94.35	121.88
.8251 in. to 1.135 in. 20.96 mm to 28.83 mm	Y	.00007	28.6 mm	94.35	121.88	28.6 mm	157.25	204.43	14.3 mm	86.49	131.69
	XX	.00002		139.56	182.81		229.98	296.81		127.77	167.08
1.1351 in. to 1.510 in. 28.83 mm to 38.35 mm	X	.00004	1 1/4 in.	104.18	135.63	1 1/4 in.	174.95	229.98	5/8 in.	96.32	123.83
	Y	.00007	31.8 mm	96.32	123.83	31.8 mm	159.22	208.37	15.9 mm	90.43	115.97
1.5101 in. to 2.010 in. 38.35 mm to 51.05 mm	XX	.00003		147.42	192.64		255.54	330.23		139.56	182.81
	X	.00006	1 3/8 in.	112.05	147.42	1 3/8 in.	190.67	247.68	11/16 in.	104.18	135.63
2.0101 in. to 2.510 in. 51.05 mm to 63.75 mm	Y	.00009	34.9 mm	110.08	145.47	34.9 mm	186.73	241.77	17.5 mm	98.29	127.77
	XX	.00003		161.19	210.32		279.13	363.65		149.39	194.60
2.5101 in. to 3.010 in. 63.75 mm to 76.45 mm	X	.00006	1 5/8 in.	119.91	157.25	1 5/8 in.	210.32	275.19	13/16 in.	110.08	143.50
	Y	.00009	41.3 mm	112.05	147.42	41.3 mm	186.73	241.77	20.6 mm	100.24	127.77
3.0101 in. to 3.510 in. 76.45 mm to 89.15 mm	XX	.00004		186.73	241.77		316.47	410.82		169.05	222.12
	X	.00008	1 7/8 in.	139.56	182.81	2 in.	235.88	308.61	7/8 in.	127.77	167.08
3.5101 in. to 4.010 in. 89.15 mm to 101.85 mm	Y	.00012	47.6 mm	119.91	157.25	50.8 mm	214.26	277.16	22.2 mm	112.05	147.42
	XX	.00004		214.26	277.16		371.51	483.56		200.50	263.41
4.0101 in. to 4.510 in. 101.85 mm to 114.55 mm	X	.00008	2 in.	157.25	209.31	2 in.	275.19	357.76	7/8 in.	151.36	196.56
	Y	.00012	50.8 mm	143.50	182.81	50.8 mm	237.85	310.58	22.2 mm	127.77	167.08
4.5101 in. to 5.010 in. 114.55 mm to 127.25 mm	XX	.00005		247.68	322.37		428.52	558.24		226.05	292.89
	X	.00010	2 in.	192.64	249.63	2 1/4 in.	318.44	412.79	1 in.	167.08	220.15
5.0101 in. to 5.510 in. 127.25 mm to 139.95 mm	Y	.00015	50.8 mm	161.19	210.32	57.2 mm	273.22	355.79	25.4 mm	145.47	188.70
	XX	.00005		277.16	361.68		505.18	656.53		263.41	343.98
5.5101 in. to 6.010 in. 139.95 mm to 152.65 mm	X	.00010	2 in.	210.32	275.19	2 1/4 in.	379.37	491.40	1 in.	198.53	259.47
	Y	.00015	50.8 mm	186.73	241.77	57.2 mm	328.26	428.52	25.4 mm	165.11	216.23
6.0101 in. to 6.510 in. 152.65 mm to 165.35 mm	XX	.00005		324.34	424.58		540.55	703.71		277.16	361.68
	X	.00010	2 1/8 in.	241.77	316.47	2 1/4 in.	428.52	558.26	1 in.	226.05	292.89
6.5101 in. to 7.010 in. 165.35 mm to 178.05 mm	Y	.00015	54.0 mm	210.32	275.19	57.2 mm	365.62	477.65	25.4 mm	192.64	249.63
	XX	.00005		365.62	477.65		591.66	768.56		304.67	397.07
7.0101 in. to 7.510 in. 178.05 mm to 190.75 mm	X	.00010	2 1/8 in.	277.16	361.68	2 1/4 in.	467.83	607.39	1 in.	239.82	312.55
	Y	.00015	54.0 mm	210.32	275.19	57.2 mm	365.62	477.65	25.4 mm	192.64	249.63
7.5101 in. to 8.010 in. 190.75 mm to 203.45 mm	XX	.000065		365.62	477.65		591.66	768.56		304.67	397.07
	X	.00013	2 in.	277.16	361.68	2 1/4 in.	467.83	607.39	1 in.	239.82	312.53
8.0101 in. to 8.510 in. 203.45 mm to 216.15 mm	Y	.00019	54.0 mm	241.77	316.47	57.2 mm	414.75	540.55	25.4 mm	220.15	285.02
	XX	.000065		448.17	585.77		682.08	886.50		351.85	483.56
8.5101 in. to 9.010 in. 216.15 mm to 228.85 mm	X	.00013	2 1/8 in.	345.95	450.14	2 1/4 in.	556.27	723.36	1 in.	286.99	373.48
	Y	.00019	54.0 mm	312.53	406.89	57.2 mm	505.18	656.53	25.4 mm	261.44	340.06
9.0101 in. to 9.510 in. 228.85 mm to 241.55 mm	XX	.000065		479.62	623.11		794.12	1,031.97		371.51	526.79
	X	.00013	2 1/8 in.	379.37	491.42	2 1/4 in.	617.22	803.95	1 in.	322.37	420.66
9.5101 in. to 10.010 in. 241.55 mm to 254.25 mm	Y	.00019	54.0 mm	345.95	450.14	57.2 mm	572.00	743.02	25.4 mm	296.81	385.27



60° Thread Measuring Wires



60° Threads

(G)				(G)			
(n) Threads per Inch	Nominal Best Wire Diameter	(C) Nominal Constant	Price (Set of Three)	(n) Threads per Inch	Nominal Best Wire Diameter	(C) Nominal Constant	Price (Set of Three)
120	0.00481	0.00722	\$ 115.76	16	0.03608	0.05413	\$70.74
100	0.00577	0.00866	115.76	14	0.04124	0.06186	70.74
96	0.00601	0.00902	115.76	13	0.04441	0.06662	70.74
90	0.00642	0.00962	115.76	12	0.04811	0.07217	70.74
80	0.00722	0.01083	115.76	11 1/2	0.05020	0.07531	70.74
72	0.00802	0.01203	115.76	11	0.05249	0.07873	70.74
64	0.00902	0.01353	115.76	10	0.05774	0.08660	70.74
56	0.01031	0.01546	115.76	9	0.06415	0.09623	70.74
50	0.01155	0.01732	115.76	8	0.07217	0.10825	70.74
48	0.01203	0.01804	70.74	7 1/2	0.07698	0.11547	70.74
44	0.01312	0.01968	70.74	7	0.08248	0.12372	70.74
40	0.01443	0.02165	70.74	6	0.09623	0.14434	70.74
36	0.01604	0.02406	70.74	5 1/2	0.10497	0.15746	115.76
32	0.01804	0.02706	70.74	5	0.11547	0.17321	115.76
30	0.01925	0.02887	70.74	4 1/2	0.12830	0.19245	115.76
28	0.02062	0.03093	70.74	4	0.14434	0.21651	115.76
27	0.02138	0.03208	70.74	3	0.16496	0.24744	115.76
26	0.02221	0.03331	70.74	3 1/2	0.17765	0.26647	115.76
24	0.02406	0.03608	70.74	3 1/4	0.19245	0.28868	115.76
22	0.02624	0.03936	70.74	2 3/4	0.20995	0.31492	115.76
20	0.02887	0.04330	70.74	2 1/2	0.23094	0.34641	115.76
18	0.03208	0.04811	70.74	2	0.28868	0.43301	115.76

60° Metric Threads

Pitch mm	Nominal Best Wire Diameter mm	Nominal Constant mm	Price (Set of Three)
.2	0.1155	0.1732	\$ 115.76
.225	0.1299	0.1949	115.76
.25	0.1443	0.2165	115.76
.3	0.1732	0.2598	115.76
.35	0.2021	0.3031	115.76
.4	0.2309	0.3464	115.76
.45	0.2598	0.3897	115.76
.5	0.2887	0.4330	115.76
.6	0.3464	0.5196	115.76
.7	0.4041	0.6062	115.76
.75	0.4330	0.6495	70.74
.8	0.4619	0.6928	70.74
.9	0.5196	0.7794	70.74
1.0	0.5774	0.8660	70.74
1.25	0.7217	1.0825	70.74
1.5	0.8660	1.2990	70.74
1.75	1.0104	1.5155	70.74
2.0	1.1547	1.7321	70.74
2.5	1.4434	2.1651	70.74
3.0	1.7321	2.5981	70.74
3.5	2.0207	3.0311	70.74
4.0	2.3094	3.4641	70.74
4.5	2.5981	3.8971	70.74
5.0	2.8868	4.3301	115.76
5.5	3.1754	4.7631	115.76
6.0	3.4641	5.1962	115.76
7.0	4.0415	6.0622	115.76
8.0	4.6188	6.9282	115.76
9.0	5.1962	7.7942	115.76
10.0	5.7735	8.6603	115.76

29° Acme Best Threads

(n) Threads per Inch	(G) Nominal Best Wire Diameter	Price (Set of Three)
1	0.51645	\$133.44
11/3	0.38734	133.44
11/2	0.34430	133.44
13/4	0.29511	133.44
2	0.25823	133.44
2 1/2	0.20658	133.44
3	0.17215	133.44
3 1/2	0.14756	106.11
4	0.12911	106.11
4 1/2	0.11477	106.11
5	0.10329	106.11
5 1/2	0.09390	106.11
6	0.08608	106.11
7	0.07378	106.11
8	0.06456	106.11
9	0.05738	106.11
10	0.05164	106.11
12	0.04304	106.11
14	0.03689	106.11
16	0.03228	106.11
18	0.02869	106.11
20	0.02582	106.11

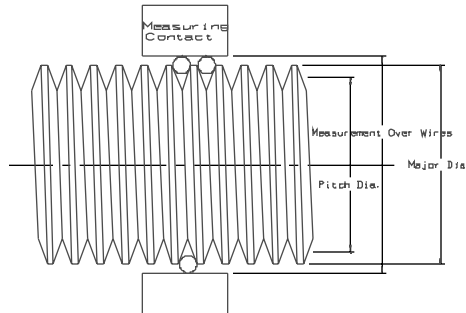

Meyer Gage Thread Measuring Wires, are manufactured as a matched set of three wires per ASME B89.1.17. Each wire diameter is matched to the others within ± 0.00001 ". The diameters of the three wires shall be within ± 0.00002 " of the calculated best wire diameter.

- 100% inspection
- 2 microfinish or better
- Tool Steel
- All members 2" long
- Meets former federal Specification GGG-W-366b for Grade A Master Thread Wires

Thread Measuring Wire Sets

60° Thread

Measuring Wires	Price
Set No. 30 HS*	\$2,440.54
30 Sizes (5 to 80 TPI) with wood case	
Set No. 34 HS	\$2,898.74
34 Sizes (4 to 80 TPI) with wood case	
Set No. 20 HS*	\$1,506.45
20 Sizes (6 to 36 TPI) with wood case	

60° Metric Thread

Measuring Wires	Price
Set No. 30M	\$3,008.06
30 Sizes (.2 pitch to 10 pitch) with wood case	
Set No. 23M	\$2,172.04
23 Sizes (.3 pitch to 6 pitch) with wood case	
* 7-1/2 & 22 TPI not included in these sets.	
** Not all sizes available	



GEAR MEASURING WIRES

- All Gear Measuring Wires meet or exceed former Fed. Spec. GGG-W-366b for Grade AM.G.W
- For three wire sets, add 50%

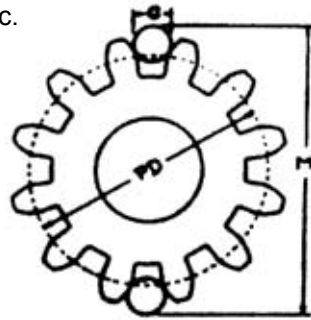

- Wires are lapped to 2 RMS micro inch finish or less and measure to exacting specifications.

GRADE A MASTER GEAR WIRES

Product Group #17-00

P	Wire Diameter for Enlarged Pinions 1.92"		Wire Diameter for External Gears 1.728"		Alternate Series 1.68"		Wire Diameter for Internal Gears 1.44"		Price (set of Two Wires)
	P	Item No.	P	Item No.	P	Item No.	P	Item No.	
2	0.96000	M706030	0.86400	M703030	0.84000	M704030	0.72000	M707030	\$115.76
2-1/2	0.76800	M706029	0.69120	M703029	0.67200	M704029	0.57600	M707029	115.76
3	0.64000	M706028	0.57600	M703028	0.56000	M704028	0.48000	M707028	115.76
4	0.48000	M706027	0.43200	M703027	0.42000	M704027	0.36000	M707027	115.76
5	0.38400	M706026	0.34560	M703026	0.33600	M704026	0.28800	M707026	80.39
6	0.32000	M706025	0.28800	M703025	0.28000	M704025	0.24000	M707025	80.39
7	0.27428	M706024	0.24686	M703024	0.24000	M704024	0.20571	M707024	80.39
8	0.24000	M706023	0.21600	M703023	0.21000	M704023	0.18000	M707023	62.70
9	0.21333	M706022	0.19200	M703022	0.18666	M704022	0.16000	M707022	62.70
10	0.19210	M706021	0.17280	M703021	0.16800	M704021	0.14400	M707021	62.70
11	0.17454	M706020	0.15709	M703020	0.15273	M704020	0.13091	M707020	62.70
12	0.16000	M706019	0.14400	M703019	0.14000	M704019	0.12000	M707019	62.70
14	0.13714	M706018	0.12343	M703018	0.12000	M704018	0.10286	M707018	62.70
16	0.12000	M706017	0.10800	M703017	0.10500	M704017	0.09000	M707017	62.70
18	0.10667	M706016	0.09600	M703016	0.09333	M704016	0.08000	M707016	62.70
20	0.09600	M706015	0.08640	M703015	0.08400	M704015	0.07200	M707015	62.70
22	0.08727	M706014	0.07855	M703014	0.07636	M704014	0.06545	M707014	62.70
24	0.08000	M706013	0.07200	M703013	0.07000	M704013	0.06000	M707013	62.70
28	0.06857	M706012	0.06171	M703012	0.06000	M704012	0.05143	M707012	62.70
32	0.06000	M706011	0.05400	M703011	0.05250	M704011	0.04500	M707011	62.70
36	0.05333	M706010	0.04800	M703010	0.04667	M704010	0.04000	M707010	62.70
40	0.04800	M706009	0.04320	M703009	0.04200	M704009	0.03600	M707009	62.70
48	0.04000	M706008	0.03600	M703008	0.03500	M704008	0.03000	M707008	62.70
64	0.03000	M706007	0.02700	M703007	0.02625	M704007	0.02250	M707007	62.70
72	0.02667	M706006	0.02400	M703006	0.02333	M704006	0.02000	M707006	62.70
80	0.02400	M706005	0.02160	M703005	0.02100	M704005	0.01800	M707005	62.70
96	0.02000	M706004	0.01800	M703004	0.01750	M704004	0.01500	M707004	62.70
100	0.01920	M706003	0.01728	M703003	0.01680	M704003	0.01440	M707003	62.70
120	0.01600	M706002	0.01440	M703002	0.01400	M704002	0.01200	M707002	98.07
128	0.01500	M706001	0.01350	M703001	0.01312	M704001	0.01125	M707001	98.07
200	0.00960	M706000	0.00864	M703000	0.00840	M704000	0.00720	M707000	98.07



3-WIRE THREAD MEASURING SYSTEM

Wire Holders - The wire holders are fitted on anvils of the micrometer allowing the single and double measuring wires to accurately position in relation to each other. The extra length of the wire enables them to be adjusted up or down in the holders. This extends the life of the wires substantially. The holders are limited to their rotational movement by the "U" Track and thus are maintained in the ideal position for engaging any lead angle of a thread.

Measuring Wires - The measuring wires are certified to meet the following specifications:

Meyer Gage Thread Measuring Wires, are manufactured as a matched set of three wires per ASM B89.1.17. Each wire diameter is matched to the others within $\pm 0.00001"$. The diameters of the three wires shall be within $0.00002"$ of the calculated best wire diameter.



All measuring wires come with a certificate, which includes the actual wire size and the constant required in determining the pitch diameter.

60 DEGREE THREAD 3-WIRE SETS WITH HOLDERS Product Group #16-20H

Threads Per Inch	Nominal Diameter	Holder Only			Price	Holders w/Wires	
		.250" Anvil	.300" Anvil	Item Nos. .375" Anvil		Item No.	Set Price
80	0.00722	M910325	M910326	M910327	\$ 277.65	M730800	\$387.30
72	0.00802	M910319	M910320	M910321	277.65	M730720	387.30
64	0.00902	M910313	M910314	M910315	258.20	M730640	367.85
56	0.01031	M910306	M910307	M910308	258.20	M730560	367.85
50	0.01155	M910303	M910304	M910305	258.20	M730500	367.85
48	0.01203	M910296	M910297	M910298	258.20	M730480	367.85
44	0.01312	M910293	M910294	M910295	258.20	M730440	367.85
40	0.01443	M910290	M910291	M910292	235.21	M730400	295.34
36	0.01604	M910283	M910284	M910285	235.21	M730360	295.34
32	0.01804	M910280	M910281	M910282	235.21	M730320	295.34
30	0.01925	M910277	M910278	M910279	235.21	M730300	295.34
28	0.02062	M910268	M910269	M910270	235.21	M730280	295.34
27	0.02138	M910265	M910266	M910267	235.21	M730270	295.34
26	0.02221	M910262	M910263	M910264	235.21	M730260	295.34
24	0.02406	M910259	M910260	M910261	235.21	M730240	295.34
22	0.02624	M910256	M910257	M910258	235.21	M730220	295.34
20	0.02887	M910253	M910254	M910255	235.21	M730200	295.34
18	0.03208	M910244	M910245	M910246	235.21	M730180	295.34
16	0.03608	M910241	M910242	M910243	235.21	M730160	295.34
14	0.04124	M910238	M910239	M910240	235.21	M730140	295.34
13	0.04441	M910235	M910236	M910237	235.21	M730130	295.34
12	0.04811	M910232	M910233	M910234	235.21	M730120	295.34
11-1/2	0.05020	M910226	M910227	M910228	235.21	M730115	295.34
11	0.05249	M910229	M910230	M910231	235.21	M730110	295.34
10	0.05774	M910223	M910224	M910225	235.21	M730100	295.34
9	0.06415	M910331	M910332	M910333	235.21	M730090	295.34
8	0.07217	M910328	M910329	M910330	235.21	M730080	295.34
7	0.08248	M910322	M910323	M910324	235.21	M730070	295.34
6	0.09623	M910316	M910317	M910318	235.21	M730060	295.34
5	0.11547	M910309	M910310	M910311	277.65	M730050	387.30

When ordering, please specify "Threads Per Inch" and Anvil Size.



3-WIRE THREAD MEASURING SYSTEM

60 DEGREE METRIC THREAD WIRE SETS WITH HOLDERS **Product Group #16-20H**

Pitch mm	Best mm	Wire Size Inch Equiv.	Holder Only Item No.			Price	Holders w/Wires	
			.250" Anvil	.300" Anvil	.375" Anvil		Item No.	Set Price
.35mm	0.2021	0.00796	M910175	M910176	M910177	\$ 277.65	M740350	\$ 410.54
.40mm	0.2309	0.00909	M910184	M910185	M910186	277.65	M740400	410.54
.45mm	0.2598	0.01023	M910181	M910182	M910183	258.20	M740450	389.92
.50mm	0.2887	0.01137	M910190	M910191	M910192	258.20	M740500	389.92
.55mm	0.3175	0.01250	M910187	M910188	M910189	258.20	M740550	389.92
.60mm	0.3464	0.01364	M910193	M910194	M910195	258.20	M740600	389.92
.70mm	0.4041	0.01591	M910199	M910200	M910201	258.20	M740700	389.92
.75mm	0.4330	0.01705	M910196	M910197	M910198	235.21	M740750	313.06
.80mm	0.4619	0.01819	M910205	M910206	M910207	235.21	M740800	313.06
.85mm	0.4907	0.01932	M910202	M910203	M910204	235.21	M740850	313.06
.90mm	0.5196	0.02046	M910208	M910209	M910210	235.21	M740900	313.06
1.00mm	0.5774	0.02273	M910211	M910212	M910213	235.21	M741000	313.06
1.25mm	0.7217	0.02841	M910214	M910215	M910216	235.21	M741250	313.06
1.50mm	0.8660	0.03409	M910217	M910218	M910219	235.21	M741500	313.06
1.75mm	1.0104	0.03978	M910220	M910221	M910222	235.21	M741750	313.06
2.00mm	1.1547	0.04546	M910247	M910248	M910249	235.21	M742000	313.06
2.50mm	1.4434	0.05683	M910250	M910251	M910252	235.21	M742500	313.06
3.00mm	1.7321	0.06819	M910271	M910272	M910273	235.21	M743000	313.06
3.50mm	2.0270	0.07980	M910274	M910275	M910276	235.21	M743500	313.06
4.00mm	2.3094	0.09092	M910286	M910287	M910288	235.21	M744000	313.06

When ordering, specify Pitch" and Anvil Size.
Individual Holders available, price on application.

THREAD MEASURING WIRE SETS **Product Group #16-00S**

	Wooden Case With Wires Only		Wooden Case w/Wires and Holders	
	Item No.	Price	Item No.	Price
60 Degree Thread Measuring Wires				
Set No. 30 HS*				
30 Sizes (5 to 80 TPI), with case	M396890	\$2,440.54	M396895	\$8,778.20
Set No. 34 HS				
34 Sizes (4 to 80 TPI), with case	M396920	\$2,898.74	M396925	\$9,984.00
Set No. 20 HS*				
20 Sizes (6 to 36 TPI), with case	M396880	\$1,506.45	M396980	\$5,498.43
Set No. 20 TC		Price on		Price on
20 Sizes (6 to 36 TPI), with case	M396990	Request	M396995	Request



60 Degree Metric Thread Measuring Wires

Set No. 30 M				
30 Sizes (.2 to 10 pitch), with case	M396910	\$3,008.06	M396915	\$9,442.19
Set No. 23 HS				
23 Sizes (.3 to 6 pitch), with case	M396900	\$2,172.04	M396905	\$7,008.09
29 Degree Acme Best Thread				
Set No. 22 AB				
22 Sizes (1 to 20 TPI), with case	M397000	\$2,686.40	N/A**	
Set No. 16 AB				
16 Sizes (3-1/2 to 20 TPI), with case	—	—	M397005	\$ 5,774.96

*7-1/2 & 22 TPI not included in these sets.
**Not all sizes available.
Case and vials are available, price on request.



Taperlock Steel Thread Plug Gages

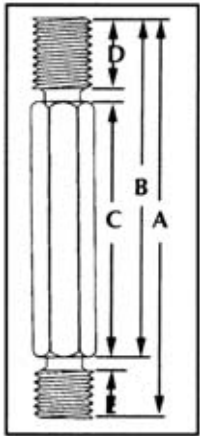

Thread plug gages are made of selected steel, manufactured with the finest equipment available, and meticulously inspected in every thread element. The name Meyer Gage is your guarantee of the finest in thread gages.

Standard in "X" tolerance.

Optional color gage handles available upon request — ideal to identify metric versus inch or master versus working gages.

The shanks on the gaging members are tapered to fit corresponding taper holes in the handles. Worn members may be removed and the handles salvaged for use with new members.

Member sizes 0 - 6 have male point in addition to length shown. Chip grooves are supplied on GO Members #10 machine screw and larger.

Nominal Size		A Overall	B GO Member & Handle	Length C Handle Only	D GO Member	E NOGO Member	Handle	
Inch	mm						Hex Size	No.
0, 1, 2, 3	1.6, 2, 2.5	2-1/2	2-1/32	1-1/2	1/4	3/16	3/16	000
4, 5, 6	3, 3.5	2-31/32	2-13/32	1-3/4	5/16	7/32	1/4	00
8, 10, 12	4, 4.5, 5	3-3/16	2-21/32	2	13/32	9/32	5/16	0
1/4, 5/16	6, 6.3, 7, 8	4-1/16	3-1/2	2-3/4	1/2	5/16	3/8	1
3/8, 7/16, 1/2	10, 12	4-5/8	4	3	3/4	3/8	1/2	2
9/16, 5/8, 3/4	14, 16, 18, 20	5-1/8	4-3/8	3-1/4	7/8	1/2	11/16	3
7/8, 1, 1-1/8	24	5-7/8	4-15/16	3-5/8	1	5/8	7/8	4
1-1/4, 1-3/8, 1-1/2		5-1/2 + D	4-3/8 + D	4	*	3/4	1	5

*D=1" for 12 threads per inch and finer; 1-1/4" for threads per inch coarser than 12. Item numbers and prices on next page.

CLASS X THREAD GAGE TOLERANCES

Thread per Inch	Tolerance Lead, Inch	Tolerance on Half Angle of Thread ± min.	Major or Minor Diameter		To and Including 1-1/2" Diameter	Tolerance on Pitch Diameter		Above 8" to 12" Diameter
			To and Including 4" Diameter	Above 4" Diameter		Above 1-1/2" to 4" Diameter	Above 4" to 8" Diameter	
80	.0002	0° 30'	.0003	—	.0002	—	—	—
72	.0002	0° 30'	.0003	—	.0002	—	—	—
64	.0002	0° 30'	.0004	—	.0002	—	—	—
56	.0002	0° 30'	.0004	—	.0002	.0003	—	—
48	.0002	0° 30'	.0004	—	.0002	.0003	—	—
40	.0002	0° 20'	.0004	—	.0002	.0003	—	—
36	.0002	0° 20'	.0004	—	.0002	.0003	—	—
32	.0003	0° 15'	.0005	.0007	.0003	.0004	.0005	.0006
28	.0003	0° 15'	.0005	.0007	.0003	.0004	.0005	.0006
27	.0003	0° 15'	.0005	.0007	.0003	.0004	.0005	.0006
24	.0003	0° 15'	.0005	.0007	.0003	.0004	.0005	.0006
20	.0003	0° 15'	.0005	.0007	.0003	.0004	.0005	.0006
18	.0003	0° 10'	.0005	.0007	.0003	.0004	.0005	.0006
16	.0003	0° 10'	.0006	.0009	.0003	.0004	.0006	.0008
14	.0003	0° 10'	.0006	.0009	.0003	.0004	.0006	.0008
13	.0003	0° 10'	.0006	.0009	.0003	.0004	.0006	.0008
12	.0003	0° 10'	.0006	.0009	.0003	.0004	.0006	.0008
11-1/2	.0003	0° 10'	.0006	.0009	.0003	.0004	.0006	.0008
11	.0003	0° 10'	.0006	.0009	.0003	.0004	.0006	.0008
10	.0003	0° 10'	.0006	.0009	.0003	.0004	.0006	.0008
9	.0003	0° 10'	.0007	.0011	.0003	.0004	.0006	.0008
8	.0004	0° 5'	.0007	.0011	.0004	.0005	.0006	.0008
7	.0004	0° 5'	.0007	.0011	.0004	.0005	.0006	.0008
6	.0004	0° 5'	.0008	.0013	.0004	.0005	.0006	.0008
5	.0004	0° 5'	.0008	.0013	—	.0005	.0006	.0008
4-1/2	.0004	0° 5'	.0008	.0013	—	.0005	.0006	.0008
4	.0004	0° 5'	.0009	.0015	—	.0005	.0006	.0008



Taperlock Steel Thread Plug Gages

- Machined from the highest quality oil hardened tool steels
- Manufactured on the latest equipment under ideal conditions
- Meticulously inspected in every thread element
- Chip grooves are supplied on all GO members #10 Machine Screw and larger
- Standard in "X" tolerance, standard A.G.D. dimensions
- Special thread plug gages available expedited delivery



HOW TO ORDER

1. Quantity and type (member only, member with handle or double end with handle).
2. Specify nominal size and threads per inch, GO and/or NOGO.
3. Class of fit: 2B or 3B.
4. Handles are not included with single members.
5. If handle is required with a single member, please specify "with handle" at time of order.
6. Include special marking instructions if any.
7. For Taperlock members with Chrome add 100%.
8. Special Thread Plug Gages price on application.
9. If Special Pitch diameter limits specify GO and NOGO gages.

TAPERLOCK STYLE WORK PLUG GAGES

Product Group #19-00T

	Nominal Size		GO Member			NOGO Member			Double End w/Handle			Handle Only	
			Class 2B or 3B Item No.	Class 2B Item No.	Class 3B Item No.	Price Per Member	Class 2B Item No.	Class 3B Item No.	Price	Size	Price		
0	80	UNF	M150100	M160100	M170100	\$57.30	M150116	M150117	\$ 129.88	000	\$16.72		
1	64	UNC	M150200	M160200	M170200	57.30	M150216	M150217	129.88	000	16.72		
1	72	UNF	M150300	M160300	M170300	57.30	M150316	M150317	129.88	000	16.72		
2	56	UNC	M150400	M160400	M170400	57.30	M150416	M150417	129.88	000	16.72		
2	64	UNF	M150500	M160500	M170500	57.30	M150516	M150517	129.88	000	16.72		
3	48	UNC	M150600	M160600	M170600	51.57	M150616	M150617	118.42	000	16.72		
3	56	UNF	M150700	M160700	M170700	51.57	M150716	M150717	118.42	000	16.72		
4	40	UNC	M150900	M160900	M170900	51.57	M150916	M150917	118.42	00	16.72		
4	48	UNF	M151000	M161000	M171000	51.57	M151016	M151017	118.42	00	16.72		
5	40	UNC	M151100	M161100	M171100	43.92	M151116	M151117	103.14	00	16.72		
5	44	UNF	M151200	M161200	M171200	43.92	M151216	M151217	103.14	00	16.72		
6	32	UNC	M151300	M161300	M171300	43.92	M151316	M151317	103.14	0	16.72		
6	40	UNF	M151400	M161400	M171400	43.92	M151416	M151417	103.14	0	16.72		
8	32	UNC	M151500	M161500	M171500	43.92	M151516	M151517	103.14	0	16.72		
8	36	UNF	M151600	M161600	M171600	43.92	M151616	M151617	103.14	0	16.72		
10	24	UNC	M151700	M161700	M171700	43.92	M151716	M151717	103.14	0	16.72		
10	32	UNF	M151800	M161800	M171800	43.92	M151816	M151817	103.14	0	16.72		
12	24	UNC	M151900	M161900	M171900	43.92	M151916	M151917	103.14	0	16.72		
12	28	UNF	M152000	M162000	M172000	43.92	M152016	M152017	103.14	0	16.72		
12	32	UNEF	M152100	M162100	M172100	59.21	M152116	M152117	133.70	0	16.72		
1/4	20	UNC	M152200	M162200	M172200	38.20	M152216	M152217	91.68	1	16.72		
1/4	28	UNF	M152300	M162300	M172300	38.20	M152316	M152317	91.68	1	16.72		
1/4	32	UNEF	M152400	M162400	M172400	74.49	M152416	M152417	164.26	1	16.72		
5/16	18	UNC	M152500	M162500	M172500	38.20	M152516	M152517	91.68	1	16.72		
5/16	24	UNF	M152600	M162600	M172600	38.20	M152616	M152617	91.68	1	16.72		
5/16	32	UNEF	M152700	M162700	M172700	74.49	M152716	M152717	164.26	1	16.72		
3/8	16	UNC	M152800	M162800	M172800	40.11	M152816	M152817	95.50	2	16.72		
3/8	24	UNF	M152900	M162900	M172900	40.11	M152916	M152917	95.50	2	16.72		
3/8	32	UNEF	M153000	M163000	M173000	85.94	M153016	M153017	187.18	2	16.72		
7/16	14	UNC	M153100	M163100	M173100	40.11	M153116	M153117	95.50	2	16.72		
7/16	20	UNF	M153200	M163200	M173200	40.11	M153216	M153217	95.50	2	16.72		
7/16	28	UNEF	M153300	M163300	M173300	85.94	M153316	M153317	187.18	2	16.72		
1/2	13	UNC	M153400	M163400	M173400	43.92	M153416	M153417	103.14	2	16.72		

continued on next page



Nominal Size			GO Member Class 2B or 3B Item No.	NOGO Member Class 2B Item No. Class 3B Item No.		Price Per Member	Double End w/Handle Class 2B Item No. Class 3B Item No. Price			Handle Only Size Price	
1/2	20	UNF	M153500	M163500	M173500	\$43.92	M153516	M153517	\$103.14	2	\$16.72
1/2	28	UNEF	M153600	M163600	M173600	87.86	M153616	M153617	191.00	2	16.72
9/16	12	UNC	M153700	M163700	M173700	57.30	M153716	M153717	129.88	3	16.72
9/16	18	UNF	M153800	M163800	M173800	57.30	M153816	M153817	129.88	3	16.72
9/16	24	UNEF	M153900	M163900	M173900	99.32	M153916	M153917	213.92	3	16.72
5/8	11	UNC	M154000	M164000	M174000	57.30	M154016	M154017	129.88	3	16.72
5/8	18	UNF	M154100	M164100	M174100	57.30	M154116	M154117	129.88	3	16.72
5/8	24	UNEF	M154200	M164200	M174200	99.32	M154216	M154217	213.92	3	16.72
11/16	24	UNEF	M154300	M164300	M174300	99.32	M154316	M154317	213.92	3	16.72
3/4	10	UNC	M154400	M164400	M174400	63.03	M154416	M154417	141.34	3	16.72
3/4	16	UNF	M154500	M164500	M174500	63.03	M154516	M154517	141.34	3	16.72
3/4	20	UNEF	M154600	M164600	M174600	101.22	M154616	M154617	217.74	3	16.72
13/16	20	UNEF	M154700	M164700	M174700	114.60	M154716	M154717	244.48	3	16.72
7/8	9	UNC	M154800	M164800	M174800	66.85	M154816	M154817	148.98	4	16.72
7/8	14	UNF	M154900	M164900	M174900	66.85	M154916	M154917	148.98	4	16.72
7/8	20	UNEF	M155000	M165000	M175000	114.60	M155016	M155017	244.48	4	16.72
15/16	20	UNEF	M155100	M165100	M175100	116.50	M155116	M155117	248.30	4	16.72
1	8	UNC	M155200	M165200	M175200	80.21	M155216	M155217	175.72	4	16.72
1	12	UNF	M155300	M165300	M175300	80.21	M155316	M155317	175.72	4	16.72
1	14	UNS	M155400	M165400	M175400	80.21	M155416	M155417	175.72	4	16.72
1	20	UNEF	M155500	M165500	M175500	131.79	M155516	M155517	278.85	4	16.72
1-1/16	18	UNEF	M155600	M165600	M175600	135.61	M155616	M155617	286.50	4	16.72
1-1/8	7	UNC	M155700	M165700	M175700	101.22	M155716	M155717	217.74	4	16.72
1-1/8	12	UNF	M155800	M165800	M175800	101.22	M155816	M155817	217.74	4	16.72
1-1/8	18	UNEF	M155900	M165900	M175900	133.70	M155916	M155917	282.67	4	16.72
1-3/16	18	UNEF	M156000	M166000	M176000	143.24	M156016	M156017	303.68	5	18.82
1-1/4	7	UNC	M156100	M166100	M176100	105.05	M156116	M156117	227.29	5	18.82
1-1/4	12	UNF	M156200	M166200	M176200	105.05	M156216	M156217	227.29	5	18.82
1-1/4	18	UNEF	M156300	M166300	M176300	137.51	M156316	M156317	292.23	5	18.82
1-5/16	18	UNEF	M156400	M166400	M176400	156.62	M156416	M156417	330.42	5	18.82
1-3/8	6	UNC	M156500	M166500	M176500	118.42	M156516	M156517	254.03	5	18.82
1-3/8	12	UNF	M156600	M166600	M176600	118.42	M156616	M156617	254.03	5	18.82
1-3/8	18	UNEF	M156700	M166700	M176700	164.26	M156716	M156717	345.70	5	18.82
1-7/16	18	UNEF	M156800	M166800	M176800	169.99	M156816	M156817	357.17	5	18.82
1-1/2	6	UNC	M156900	M166900	M176900	133.70	M156916	M156917	284.59	5	18.82
1-1/2	12	UNF	M157000	M167000	M177000	133.70	M157016	M157017	284.59	5	18.82
1-1/2	18	UNEF	M157100	M167100	M177100	175.72	M157116	M157117	368.63	5	18.82



TRILOCK REVERSIBLE STEEL THREAD PLUG GAGES

- Trilock gages are reversible, doubling gage wear life.
- When worn out at one end, they may be reversed on the specially designed handle and the unused end can be put to use.
- Available as Class 2B.
- Gage member is held on the handle by means of a socket head cap screw.
- For chrome, add 100%.
- For class 3B, price on application.
- Standard in Class X tolerance.

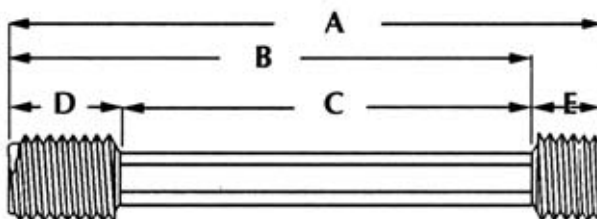

• *General Dimensions*

Nominal Size	A	B	Length C	D	E	Handle	
	Overall	GO Member & Handle	Handle Only	GO Member	NOGO Member	Handle Hex Size	No.
7/8	5-3/4	5	4	1	3/4	1/2	2-1/2
1	5-7/8	5-1/8	4	1-1/8	3/4	5/8	3-1/2
1-1/8-7	6-1/8	5-3/8	4	1-3/8	3/4	5/8	3-1/2
1-1/8-12	5-7/8	5-1/8	4	1-1/8	3/4	5/8	3-1/2
1-1/4-7	5-7/8	5-1/2	4	1-1/8	3/4	13/16	4-1/2
1-1/4-12	6	5-1/4	4	1-1/4	3/4	13/16	4-1/2
1-3/8-6, 1-1/2-6	6-1/4	5-1/2	4	1-1/2	3/4	13/16	4-1/2
1-3/8-12, 1-1/2-12	6	5-1/4	4	1-1/4	3/4	13/16	4-1/2

TRILOCK REVERSIBLE STYLE

Product Group #19-00TRI

Nominal Size	GO Member			NOGO Member		Double End w/Handle		Handle Only	
	Class 2B or 3B	Class 2B	Class 2B	Class 2B	Class 2B	Class 2B	Class 2B	No.	Price
	Item No.	Item No.	Item No.	Item No.	Item No.	Item No.	Item No.		
7/8 9 UN	M104800	M114800	M114800	\$ 108.87	M104811	\$ 238.75	M104811	2-1/2	\$ 23.00
7/8 14 UN	M104900	M114900	M114900	108.87	M104911	238.75	M104911	2-1/2	23.00
1 8 UN	M105200	M115200	M115200	120.33	M105211	261.67	M105211	3-1/2	23.00
1 12 UN	M105300	M115300	M115300	120.33	M105311	261.67	M105311	3-1/2	23.00
1-1/8 7 UN	M105700	M115700	M115700	145.16	M105711	311.33	M105711	3-1/2	23.00
1-1/8 12 UN	M105800	M115800	M115800	145.16	M105811	311.33	M105811	3-1/2	23.00
1-1/4 7 UN	M106100	M116100	M116100	162.35	M106111	347.62	M106111	4-1/2	25.09
1-1/4 12 UN	M106200	M116200	M116200	162.35	M106211	347.62	M106211	4-1/2	25.09
1-3/8 6 UN	M106500	M116500	M116500	191.00	M106511	404.92	M106511	4-1/2	25.09
1-3/8 12 UN	M106600	M116600	M116600	191.00	M106611	404.92	M106611	4-1/2	25.09
1-1/2 6 UN	M106900	M116900	M116900	221.56	M106911	466.04	M106911	4-1/2	25.09
1-1/2 12 UN	M107000	M117000	M117000	221.56	M107011	466.04	M107011	4-1/2	25.09

Handles are not included with single members. If handles are required for GO or NOGO members, specify "with handle".

3B Gages are available and priced the same as 2B Gages.

When ordering, please use items numbers.



HELICAL COIL TAPERLOCK STEEL GAGES (STI)

- Standard in Class X Tolerance.
- Handles are not included with single members.
- If handles are required for GO or NOGO members, specify "with handle".
- For "W" Tolerance add 33.3%.
- Titanium Nitride coated members available, price on application.
- Larger sizes available, price on application.
- Metric sizes available, price on application.

HOW TO ORDER

1. Specify quantity and type (members only, member with handle or double end with handle).
2. Specify nominal diameter and threads per inch GO and/or NOGO.
3. Select class of fit, 2B or 3B.
4. Special marking instructions, if any.
5. If handle is required with a single member, please specify "with handle" at time of order.

HOW TO PRICE

1. Select desired size and class of fit.
2. For chrome, add 100%.

HELICOIL GAGES (STI)			Product Group #19-00THC								
Nominal Size	GO Member		NOGO Member		Double End w/Handle			Handle Only			
	Class 2B or 3B Item No.	Class 2B Item No.	Class 3B Item No.	Price	Class 2B Item No.	Class 3B Item No.	Price	No.	Price		
2 56 UNC	M550400	M560400	M570400	\$ 95.50	M550456	M550457	\$ 206.28	00	\$ 16.72		
4 40 UNC	M550900	M560900	M570900	84.04	M550956	M550957	183.36	00	16.72		
6 32 UNC	M551300	M561300	M571300	76.40	M551356	M551357	168.08	0	16.72		
8 32 UNC	M551500	M561500	M571500	76.40	M551556	M551557	168.08	0	16.72		
10 24 UNC	M551700	M561700	M571700	76.40	M551756	M551757	168.08	0	16.72		
10 32 UNF	M551800	M561800	M571800	76.40	M551856	M551857	168.08	0	16.72		
1/4 20 UNC	M552200	M562200	M572200	70.67	M552256	M552257	156.62	1	16.72		
1/4 28 UNF	M552300	M562300	M572300	70.67	M552356	M552357	156.62	1	16.72		
5/16 18 UNC	M552500	M562500	M572500	70.67	M552556	M552557	156.62	2	16.72		
5/16 24 UNF	M552600	M562600	M572600	70.67	M552656	M552657	156.62	2	16.72		
3/8 16 UNC	M552800	M562800	M572800	76.40	M552856	M552857	168.08	2	16.72		
3/8 24 UNF	M552900	M562900	M572900	76.40	M552956	M552957	168.08	2	16.72		
7/16 20 UNF	M553200	M563200	M573200	76.40	M553256	M553257	168.08	3	16.72		
1/2 13 UNC	M553400	M563400	M573400	78.31	M553456	M553457	171.90	3	16.72		
1/2 20 UNF	M553500	M563500	M573500	78.31	M553556	M553557	171.90	3	16.72		



REVERSIBLE STEEL THREAD PLUG GAGES

HOW TO ORDER

1. Specify quantity and type (members only, member with handle or double end with handle).
2. Specify nominal diameter and threads per inch GO and/or NOGO.
3. Select class of fit, 2B or 3B.
4. Special marking instructions, if any.
5. If handle is required with a single member, please specify "with handle" at time of order.

HOW TO PRICE

1. Select desired size and class of fit.
2. For Chrome, add 100%.

REVERSIBLE STYLE WORK PLUG GAGES Product Group #19-00W REV

Nominal Size			NOGO			Double End w/Handle		Handle Only	
			GO Member Item No.	Class 2B Item No.	Price	Class 2B Item No.	Price	No.	Price
0	80	UNF	M100100	M110100	\$ 70.67	M100111	\$ 158.53	1W	\$ 18.82
1	64	UNC	M100200	M110200	70.67	M100211	158.53	1W	18.82
1	72	UNF	M100300	M110300	70.67	M100311	158.53	1W	18.82
2	56	UNC	M100400	M110400	70.67	M100411	158.53	2W	18.82
2	64	UNF	M100500	M110500	70.67	M100511	158.53	2W	18.82
3	48	UNC	M100600	M110600	66.85	M100611	150.89	2W	18.82
3	56	UNF	M100700	M110700	66.85	M100711	150.89	2W	18.82
4	40	UNC	M100900	M110900	66.85	M100911	150.89	2W	18.82
4	48	UNF	M101000	M111000	66.85	M101011	150.89	2W	18.82
5	40	UNC	M101100	M111100	59.21	M101111	135.61	2W	18.82
5	44	UNF	M101200	M111200	59.21	M101211	135.61	2W	18.82
6	32	UNC	M101300	M111300	59.21	M101311	135.61	2W	18.82
6	40	UNF	M101400	M111400	59.21	M101411	135.61	2W	18.82
8	32	UNC	M101500	M111500	59.21	M101511	135.61	2W	18.82
8	36	UNF	M101600	M111600	59.21	M101611	135.61	2W	18.82
10	24	UNC	M101700	M111700	59.21	M101711	137.52	3W	20.90
10	32	UNF	M101800	M111800	59.21	M101811	137.52	3W	20.90
12	24	UNC	M101900	M111900	59.21	M101911	137.52	3W	20.90
12	28	UNF	M102000	M112000	59.21	M102011	137.52	3W	20.90
12	32	UNEF	M102100	M112100	87.86	M102111	194.82	3W	20.90
1/4	20	UNC	M102200	M112200	53.48	M102211	126.06	3W	20.90
1/4	28	UNF	M102300	M112300	53.48	M102311	126.06	3W	20.90
1/4	32	UNEF	M102400	M112400	80.22	M102411	179.54	3W	20.90
5/16	18	UNC	M102500	M112500	53.48	M102511	127.97	4W	23.00
5/16	24	UNF	M102600	M112600	53.48	M102611	127.97	4W	23.00
5/16	32	UNEF	M102700	M112700	80.22	M102711	181.45	4W	23.00
3/8	8-	UNC	M102800	M112800	59.21	M102811	139.43	4W	23.00
3/8	24	UNF	M102900	M112900	59.21	M102911	139.43	4W	23.00
3/8	32	UNEF	M103000	M113000	87.86	M103011	196.73	4W	23.00
7/16	14	UNC	M103100	M113100	59.21	M103111	141.34	5W	25.09
7/16	20	UNF	M103200	M113200	59.21	M103211	141.34	5W	25.09
7/16	28	UNEF	M103300	M113300	87.86	M103311	198.64	5W	25.09
1/2	13	UNC	M103400	M113400	59.21	M103411	141.34	5W	25.09
1/2	20	UNF	M103500	M113500	59.21	M103511	141.34	5W	25.09
1/2	28	UNEF	M103600	M113600	87.86	M103611	198.64	5W	25.09
9/16	12	UNC	M103700	M113700	59.21	M103711	143.25	6W	27.18
9/16	18	UNF	M103800	M113800	59.21	M103811	143.25	6W	27.18
9/16	24	UNEF	M103900	M113900	87.86	M103911	200.55	6W	27.18
5/8	11	UNC	M104000	M114000	59.21	M104011	143.25	6W	27.18
5/8	18	UNF	M104100	M114100	59.21	M104111	143.25	6W	27.18
5/8	24	UNEF	M104200	M114200	89.77	M104211	181.45	6W	27.18
11/16	24	UNEF	M104300	M114300	91.68	M104311	213.92	7W	33.45
3/4	10	UNC	M104400	M114400	76.40	M104411	183.36	7W	33.45
3/4	16	UNF	M104500	M114500	76.40	M104511	183.36	7W	33.45
3/4	20	UNEF	M104600	M114600	118.42	M104611	267.40	7W	33.45



THREAD RING GAGES

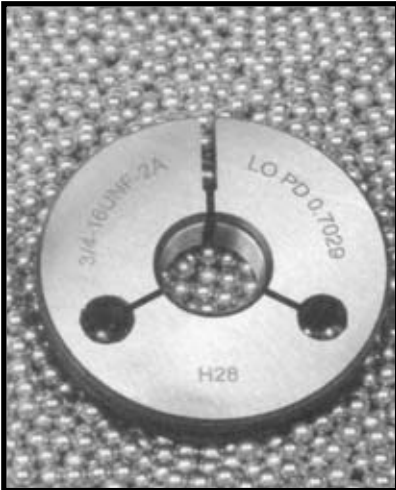

- Manufactured from selected graphite steels to American Gage Design (AGD Style).
- Machined and accurately lapped for an exacting thread size.
- Meticulously inspected in every element.
- Best if purchased with and mated to a setting plug gage at the time of order.
- NOGO rings are furnished with an identifying groove around the rim of the gage.
- Optional Thread Ring Gage Holders available, optional.
- Class 2 and Class 3 available on request.

HOW TO ORDER

1. Specify nominal diameter, pitch and class of fit 2A, 3A, or Basic.
2. Setting Plugs should be ordered at the same time as the corresponding ring gages.
3. Request Ring Gages be set with new Set Plug before shipping.
4. Left hand available, price on application.
5. Larger sizes available, price on application.
6. Specials available, price on application.
7. Chrome available on rings, add 100%.

RING GAGES

Product Group #19-00R

Nominal Size	GO Ring Gage			NOGO Ring Gage			Holder Only	
	Class 2A Item No.	Class 3A/Basic Item No.	Price	Class 2A Item No.	Class 3A Item No.	Price	No.	Price
0 80 UNF	M240100	M250100	\$ 233.02	M260100	M270100	\$ 233.02	1	\$29.28
1 64 UNC	M240200	M250200	210.10	M260200	M270200	210.10	1	29.28
1 72 UNF	M240300	M250300	210.10	M260300	M270300	210.10	1	29.28
2 56 UNC	M240400	M250400	173.81	M260400	M270400	173.81	1	29.28
2 64 UNF	M240500	M250500	173.81	M260500	M270500	173.81	1	29.28
3 48 UNC	M240600	M250600	173.81	M260600	M270600	173.81	1	29.28
3 56 UNF	M240700	M250700	173.81	M260700	M270700	173.81	1	29.28
4 40 UNC	M240900	M250900	158.53	M260900	M270900	158.53	1	29.28
4 48 UNF	M241000	M251000	158.53	M261000	M271000	158.53	1	29.28
5 40 UNC	M241100	M251100	135.61	M261100	M271100	135.61	1	29.28
5 44 UNF	M241200	M251200	135.61	M261200	M271200	135.61	1	29.28
6 32 UNC	M241300	M251300	137.52	M261300	M271300	137.52	1	29.28
6 40 UNF	M241400	M251400	137.52	M261400	M271400	137.52	1	29.28
8 32 UNC	M241500	M251500	145.16	M261500	M271500	145.16	1	29.28
8 36 UNF	M241600	M251600	145.16	M261600	M271600	145.16	1	29.28
10 24 UNC	M241700	M251700	145.16	M261700	M271700	145.16	1	29.28
10 32 UNF	M241800	M251800	145.16	M261800	M271800	145.16	1	29.28
12 24 UNC	M241900	M251900	145.16	M261900	M271900	145.16	1	29.28
12 28 UNF	M242000	M252000	145.16	M262000	M272000	145.16	1	29.28
12 32 UNEF	M242100	M252100	169.99	M262100	M272100	169.99	1	29.28
1/4 20 UNC	M242200	M252200	127.97	M262200	M272200	127.97	2	33.47
1/4 28 UNF	M242300	M252300	127.97	M262300	M272300	127.97	2	33.47
1/4 32 UNEF	M242400	M252400	169.99	M262400	M272400	169.99	2	33.47
5/16 18 UNC	M242500	M252500	127.97	M262500	M272500	127.97	2	33.47
5/16 24 UNF	M242600	M252600	127.97	M262600	M272600	127.97	2	33.47
5/16 32 UNEF	M242700	M252700	169.99	M262700	M272700	169.99	2	33.47
3/8 16 UNC	M242800	M252800	135.61	M262800	M272800	135.61	3	37.64
3/8 24 UNF	M242900	M252900	135.61	M262900	M272900	135.61	3	37.64
3/8 32 UNEF	M243000	M253000	175.72	M263000	M273000	175.72	3	37.64
7/16 14 UNC	M243100	M253100	135.61	M263100	M273100	135.61	3	37.64
7/16 20 UNF	M243200	M253200	135.61	M263200	M273200	135.61	3	37.64
7/16 28 UNEF	M243300	M253300	175.72	M263300	M273300	175.72	3	37.64
1/2 13 UNC	M243400	M253400	150.89	M263400	M273400	150.89	3	37.64
1/2 20 UNF	M243500	M253500	150.89	M263500	M273500	150.89	3	37.64
1/2 28 UNEF	M243600	M253600	192.91	M263600	M273600	192.91	3	37.64
9/16 12 UNC	M243700	M253700	169.99	M263700	M273700	169.99	4	46.00
9/16 18 UNF	M243800	M253800	169.99	M263800	M273800	169.99	4	46.00
9/16 24 UNEF	M243900	M253900	204.37	M263900	M273900	204.37	4	46.00



THREAD RING GAGES

RING GAGES (continued)

Product Group #19-00R

Nominal Size	GO Ring Gage			NOGO Ring Gage			Holder Only	
	Class 2A Item No.	Class 3A/Basic Item No.	Price	Class 2A Item No.	Class 3A Item No.	Price	No.	Price
5/8 11 UNC	M244000	M254000	\$169.99	M264000	M274000	\$169.99	4	\$46.00
5/8 18 UNF	M244100	M254100	169.99	M264100	M274100	169.99	4	46.00
5/8 24 UNEF	M244200	M254200	206.28	M264200	M274200	206.28	4	46.00
11/16 24 UNEF	M244300	M254300	208.19	M264300	M274300	208.19	4	46.00
3/4 10 UNC	M244400	M254400	221.56	M264400	M274400	221.56	4	46.00
3/4 16 UNF	M244500	M254500	221.56	M264500	M274500	221.56	4	46.00
3/4 20 UNEF	M244600	M254600	250.21	M264600	M274600	250.21	4	46.00
13/16 20 UNEF	M244700	M254700	254.03	M264700	M274700	254.03	4	46.00
7/8 9 UNC	M244800	M254800	248.30	M264800	M274800	248.30	5	58.54
7/8 14 UNF	M244900	M254900	248.30	M264900	M274900	248.30	5	58.54
7/8 20 UNEF	M245000	M255000	267.40	M265000	M275000	267.40	5	58.54
15/16 20 UNEF	M245100	M255100	275.04	M265100	M275100	275.04	5	58.54
1 8 UNC	M245200	M255200	296.05	M265200	M275200	296.05	5	58.54
1 12 UNF	M245300	M255300	296.05	M265300	M275300	296.05	5	58.54
1 14 UNS	M245400	M255400	296.05	M265400	M275400	296.05	5	58.54
1 20 UNEF	M245500	M255500	313.24	M265500	M275500	313.24	5	58.54
1-1/16 18 UNEF	M245600	M255600	322.79	M265600	M275600	322.79	5	58.54
1-1/8 8 UNC	M245700	M255700	322.79	M265700	M275700	322.79	5	58.54
1-1/8 12 UNF	M245800	M255800	322.79	M265800	M275800	322.79	5	58.54
1-1/8 18 UNEF	M245900	M255900	343.80	M265900	M275900	343.80	5	58.54
1-3/16 18 UNEF	M246000	M256000	355.26	M266000	M276000	355.26	5	58.54
1-1/4 7 UNC	M246100	M256100	357.17	M266100	M276100	357.17	6	71.07
1-1/4 12 UNF	M246200	M256200	357.17	M266200	M276200	357.17	6	71.07
1-1/4 18 UNEF	M246300	M256300	372.45	M266300	M276300	372.45	6	71.07
1-5/16 18 UNEF	M246400	M256400	383.91	M266400	M276400	383.91	6	71.07
1-3/8 6 UNC	M246500	M256500	395.37	M266500	M276500	395.37	6	71.07
1-3/8 12 UNF	M246600	M256600	395.37	M266600	M276600	395.37	6	71.07
1-3/8 18 UNEF	M246700	M256700	418.29	M266700	M276700	418.29	6	71.07
1-7/16 18 UNEF	M246800	M256800	424.02	M266800	M276800	424.02	6	71.07
1-1/2 6 UNC	M246900	M256900	439.30	M266900	M276900	439.30	6	71.07
1-1/2 12 UNF	M247000	M257000	439.30	M267000	M277000	439.30	6	71.07
1-1/2 18 UNEF	M247100	M257100	456.49	M267100	M277100	456.49	6	71.07



TRUNCATED THREAD SETTING PLUGS

- Truncated type thread setting plugs have a full form threaded portion and a truncated portion.
- The full form portion checks the pitch diameter and major diameter clearance.
- The Truncated portion checks pitch diameter and flank angle wear.
- Made from selected steels, ground and accurately lapped.
- Meticulously inspected in every thread element.
- Standard thread setting plugs are Class X tolerance on pitch diameter, while holding "W" tolerance on lead and angles.
- For Class "W" tolerance on pitch diameter, add 50%.

HOW TO ORDER

1. Specify Quantity.
2. Specify nominal size, pitch and class of fit 2A or 3A.
3. Handles are not included with single members. If handles are required for GO or NOGO members, specify "with handles" at time of order.
4. Setting Plugs should be ordered at the same time as the corresponding ring gages.
5. Request Ring Gages be set with new Set Plug before shipping.
6. For Class "W" tolerance, add 50%.
7. Left hand available, price on application.
8. Specials available, price on application.

TRUNCATED SETTING PLUGS Product Group #19-00S

Nominal Size	GO Member			NOGO Member			GO-NOGO w/handle			Handle Only	
	Class 2A Item No.	Class 3A/Basic Item No.	Class 2A Item No.	Class 3A Item No.	Price	Class 2A Item No.	Class 3A Item No.	Price	No.	Price	
0 80 UNF	M300100	M310100	M320100	M330100	\$131.79	M300132	M310133	\$ 278.86	000	\$16.72	
1 64 UNC	M300200	M310200	M320200	M330200	131.79	M300232	M310233	278.86	000	16.72	
1 72 UNF	M300300	M310300	M320300	M330300	131.79	M300332	M310333	278.86	000	16.72	
2 56 UNC	M300400	M310400	M320400	M330400	131.79	M300432	M310433	278.86	000	16.72	
2 64 UNF	M300500	M310500	M320500	M330500	131.79	M300532	M310533	278.86	000	16.72	
3 48 UNC	M300600	M310600	M320600	M330600	122.24	M300632	M310633	259.76	000	16.72	
3 56 UNF	M300700	M310700	M320700	M330700	122.24	M300732	M310733	259.76	000	16.72	
4 40 UNC	M300900	M310900	M320900	M330900	122.24	M300932	M310933	259.76	00	16.72	
4 48 UNF	M301000	M311000	M321000	M331000	122.24	M301032	M311033	259.76	00	16.72	
5 40 UNC	M301100	M311100	M321100	M331100	114.60	M301132	M311133	244.48	00	16.72	
5 44 UNF	M301200	M311200	M321200	M331200	114.60	M301232	M311233	244.48	00	16.72	
6 32 UNC	M301300	M311300	M321300	M331300	114.60	M301332	M311333	244.48	00	16.72	
6 40 UNF	M301400	M311400	M321400	M331400	114.60	M301432	M311433	244.48	00	16.72	
8 32 UNC	M301500	M311500	M321500	M331500	114.60	M301532	M311533	244.48	0	16.72	
8 36 UNF	M301600	M311600	M321600	M331600	114.60	M301632	M311633	244.48	0	16.72	
10 24 UNC	M301700	M311700	M321700	M331700	114.60	M301732	M311733	244.48	0	16.72	
10 32 UNF	M301800	M311800	M321800	M331800	114.60	M301832	M311833	244.48	0	16.72	
12 24 UNC	M301900	M311900	M321900	M331900	122.24	M301932	M311933	259.76	0	16.72	
12 28 UNF	M302000	M312000	M322000	M332000	122.24	M302032	M312033	259.76	0	16.72	
12 32 UNEF	M302100	M312100	M322100	M332100	147.07	M302132	M312133	309.42	0	16.72	
1/4 20 UNC	M302200	M312200	M322200	M332200	105.05	M302232	M312233	225.38	1	16.72	
1/4 28 UNF	M302300	M312300	M322300	M332300	105.05	M302332	M312333	225.38	1	16.72	
1/4 32 UNEF	M302400	M312400	M322400	M332400	150.89	M302432	M312433	317.06	1	16.72	
5/16 18 UNC	M302500	M312500	M322500	M332500	105.05	M302532	M312533	225.38	1	16.72	
5/16 24 UNF	M302600	M312600	M322600	M332600	105.05	M302632	M312633	225.38	1	16.72	
5/16 32 UNEF	M302700	M312700	M322700	M332700	150.89	M302732	M312733	317.06	1	16.72	
3/8 16 UNC	M302800	M312800	M322800	M332800	108.87	M302832	M312833	233.02	2	16.72	
3/8 24 UNF	M302900	M312900	M322900	M332900	108.87	M302932	M312933	233.02	2	16.72	
3/8 32 UNEF	M303000	M313000	M323000	M333000	175.72	M303032	M313033	366.72	2	16.72	
7/16 14 UNC	M303100	M313100	M323100	M333100	116.51	M303132	M313133	248.30	2	16.72	
7/16 20 UNF	M303200	M313200	M323200	M333200	116.51	M303232	M313233	248.30	2	16.72	
7/16 28 UNEF	M303300	M313300	M323300	M333300	175.72	M303332	M313333	366.72	2	16.72	

continued on the next page



TRUNCATED THREAD SETTING PLUGS

TRUNCATED SETTING PLUGS (continued)

Product Group #19-00S

Nominal Size	GO Member			NOGO Member			GO-NOGO w/handle			Handle Only	
	Class 2A Item No.	Class 3A/Basic Item No.	Class 2A Item No.	Class 3A Item No.	Price	Class 2A Item No.	Class 3A Item No.	Price	No.	Price	
1/2 13 UNC	M303400	M313400	M323400	M333400	\$118.42	M303432	M313433	\$252.12	2	\$16.72	
1/2 20 UNF	M303500	M313500	M323500	M333500	118.42	M303532	M313533	252.12	2	16.72	
1/2 28 UNEF	M303600	M313600	M323600	M333600	194.82	M303632	M313633	404.92	2	16.72	
9/16 12 UNC	M303700	M313700	M323700	M333700	135.61	M303732	M313733	286.50	3	16.72	
9/16 18 UNF	M303800	M313800	M323800	M333800	135.61	M303832	M313833	286.50	3	16.72	
9/16 24 UNEF	M303900	M313900	M323900	M333900	208.19	M303932	M313933	431.66	3	16.72	
5/8 11 UNC	M304000	M314000	M324000	M334000	141.34	M304032	M314033	297.96	3	16.72	
5/8 18 UNF	M304100	M314100	M324100	M334100	141.34	M304132	M314133	297.96	3	16.72	
5/8 24 UNEF	M304200	M314200	M324200	M334200	210.10	M304232	M314233	435.48	3	16.72	
11/16 24 UNEF	M304300	M314300	M324300	M334300	229.20	M304332	M314333	473.68	3	16.72	
3/4 10 UNC	M304400	M314400	M324400	M334400	164.26	M304432	M314433	343.80	3	16.72	
3/4 16 UNF	M304500	M314500	M324500	M334500	164.26	M304532	M314533	343.80	3	16.72	
3/4 20 UNEF	M304600	M314600	M324600	M334600	221.56	M304632	M314633	458.40	3	16.72	
13/16 20 UNEF	M304700	M314700	M324700	M334700	234.93	M304732	M314733	485.14	3	16.72	
7/8 8 UNC	M304800	M314800	M324800	M334800	192.91	M304832	M314833	401.10	4	16.72	
7/8 14 UNF	M304900	M314900	M324900	M334900	192.91	M304932	M314933	401.10	4	16.72	
7/8 20 UNEF	M305000	M315000	M325000	M335000	240.66	M305032	M315033	496.60	4	16.72	
15/16 20 UNEF	M305100	M315100	M325100	M335100	244.48	M305132	M315133	504.24	4	16.72	
1 8 UNC	M305200	M315200	M325200	M335200	221.56	M305232	M315233	458.40	4	16.72	
1 12 UNF	M305300	M315300	M325300	M335300	221.56	M305332	M315333	458.40	4	16.72	
1 14 UNS	M305400	M315400	M325400	M335400	221.56	M305432	M315433	458.40	4	16.72	
1 20 UNEF	M305500	M315500	M325500	M335500	261.67	M305532	M315533	538.61	4	16.72	
1-1/16 18 UNEF	M305600	M315600	M325600	M335600	259.76	M305632	M315633	534.79	4	16.72	
1-1/8 7 UNC	M305700	M315700	M325700	M335700	259.76	M305732	M315733	534.79	4	16.72	
1-1/8 12 UNF	M305800	M315800	M325800	M335800	259.76	M305832	M315833	534.79	4	16.72	
1-1/8 18 UNEF	M305900	M315900	M325900	M335900	273.13	M305932	M315933	561.53	4	16.72	
1-3/16 18 UNEF	M306000	M316000	M326000	M336000	273.13	M306032	M316033	563.44	5	18.82	
1-1/4 7 UNC	M306100	M316100	M326100	M336100	282.68	M306132	M316133	582.54	5	18.82	
1-1/4 12 UNF	M306200	M316200	M326200	M336200	282.68	M306232	M316233	582.54	5	18.82	
1-1/4 18 UNEF	M306300	M316300	M326300	M336300	318.97	M306332	M316333	655.12	5	18.82	
1-5/16 18 UNEF	M306400	M316400	M326400	M336400	324.70	M306432	M316433	666.58	5	18.82	
1-3/8 6 UNC	M306500	M316500	M326500	M336500	326.61	M306532	M316533	670.40	5	18.82	
1-3/8 12 UNF	M306600	M316600	M326600	M336600	326.61	M306632	M316633	670.40	5	18.82	
1-3/8 18 UNEF	M306700	M316700	M326700	M336700	336.16	M306732	M316733	689.50	5	18.82	
1-7/16 18 UNEF	M306800	M316800	M326800	M336800	345.71	M306832	M316833	708.60	5	18.82	
1-1/2 6 UNC	M306900	M316900	M326900	M336900	349.53	M306932	M316933	716.24	5	18.82	
1-1/2 12 UNF	M307000	M317000	M327000	M337000	349.53	M307032	M317033	716.24	5	18.82	
1-1/2 18 UNEF	M307100	M317100	M327100	M337100	360.99	M307132	M317133	739.16	5	18.82	

The shanks on the gaging members are tapered to fit corresponding tapered holes in the handle.
Worn members may be removed and the handle salvaged for use with new members.
Member sizes 0-6 have a male point in addition to the lengths shown.



METRIC STEEL TAPERLOCK THREAD PLUG GAGES

- Standard in 6H tolerance.
- For Taperlocks with chrome, add 100%.
- Left hand available, price on application
- Larger sizes available, price on application.

HOW TO ORDER

1. Specify quantity.
2. Specify nominal diameter and threads per inch.
3. Specify special markings instructions, if any.

HOW TO PRICE

1. Select desired size

METRIC STEEL TAPERLOCK THREAD PLUG GAGES **Product Group #19-00MT**

Metric Size & Pitch	GO Member	NOGO Member	Price	Double End w/Handle	Price	Handle Only	
	Item No.	Item No.		Item No.		Size	Price
M1.6 X 0.35	M20100901	M20100913	\$ 70.67	M20100963	\$ 156.62	000	\$16.72
M1.8 X 0.35	M20101101	M20101113	70.67	M20101163	156.62	000	16.72
M2.0 X 0.40	M20101301	M20101313	70.67	M20101363	156.62	000	16.72
M2.2 X 0.45	M20101501	M20101513	70.67	M20101563	156.62	000	16.72
M2.5 X 0.45	M227200	M237200	64.94	M227223	145.16	000	16.72
M3.0 X 0.50	M227300	M237300	64.94	M227323	145.16	00	16.72
M3.5 X 0.60	M227400	M237400	57.30	M227423	129.88	00	16.72
M4.0 X 0.70	M227500	M237500	57.30	M227523	129.88	0	16.72
M4.5 X 0.75	M20102501	M20102513	59.21	M20102563	133.70	0	16.72
M5.0 X 0.80	M227600	M237600	57.30	M227623	129.88	0	16.72
M6.0 X 1.00	M227700	M237700	47.75	M227723	110.78	1	16.72
M7.0 X 1.00	M20103201	M20103213	49.66	M20103263	114.60	1	16.72
M8.0 X 1.00	M20103501	M20103513	45.84	M20103563	106.96	1	16.72
M8.0 X 1.25	M227800	M237800	45.84	M227823	106.96	1	16.72
M10.0 X 1.50	M228000	M238000	49.66	M228023	114.60	2	16.72
M10.0 X 1.25	M228100	M238100	49.66	M228123	114.60	2	16.72
M12.0 X 1.75	M228300	M238300	53.48	M228323	122.24	2	16.72
M12.0 X 12.00	M228400	M238400	53.48	M228423	122.24	2	16.72
M12.0 X 1.25	M228500	M238500	53.48	M228523	122.24	2	16.72
M14.0 X 2.00	M228700	M238700	61.12	M228723	137.52	3	16.72
M14.0 X 1.50	M228800	M238800	61.12	M228823	137.52	3	16.72
M16.0 X 2.00	M229000	M239000	61.12	M229023	137.52	3	16.72
M16.0 X 1.50	M229100	M239100	61.12	M229123	137.52	3	16.72
M17.0 X 1.00	M229200	M239200	64.94	M229223	145.16	3	16.72
M18.0 X 2.50	M20106201	M20106213	68.76	M20106263	152.80	3	16.72
M18.0 X 1.50	M229300	M239300	64.94	M229323	152.80	3	16.72
M20.0 X 2.50	M229400	M239400	78.31	M229423	152.80	3	16.72
M20.0 X 1.50	M229500	M239500	78.31	M229523	152.80	3	16.72
M22.0 X 2.50	M20107001	M20107013	78.31	M20107063	194.82	4	16.72
M22.0 X 1.50	M20107201	M20107213	78.31	M20107263	152.80	4	16.72
M24.0 X 3.00	M20107401	M20107413	89.77	M20107463	194.82	4	16.72
M24.0 X 2.00	M20107501	M20107513	89.77	M20107563	194.82	4	16.72
M27.0 X 3.00	M20108201	M20108213	122.24	M20108263	259.76	4	16.72
M27.0 X 2.00	M20108301	M20108313	122.24	M20108363	259.76	4	16.72
M30.0 X 3.50	M20108901	M20108913	147.07	M20108963	311.33	5	18.82
M30.0 X 2.00	M20109101	M20109113	147.07	M20109163	311.33	5	18.82
M33.0 X 3.50	M20109601	M20109613	147.07	M20109663	311.33	5	18.82
M33.0 X 2.00	M20109801	M20109813	147.07	M20109863	311.33	5	18.82
M36.0 X 4.00	M20110101	M20110113	169.99	M20110163	357.17	5	18.82
M36.0 X 3.00	M20110201	M20110213	169.99	M20110263	357.17	5	18.82



REVERSIBLE METRIC STEEL THREAD PLUGS

- Standard in 6H tolerance.
- For chrome, add 100%.
- Left hand available, price on application
- Larger sizes available, price on application.

HOW TO ORDER

1. Specify quantity.
2. Specify nominal diameter and threads per inch.
3. Specify special markings instructions, if any.

HOW TO PRICE

1. Select desired size

REVERSIBLE METRIC THREAD PLUGS Product Group #19-00H

Metric Size & Pitch Coarse	Go Member	No Go Member	Price	Double End w/Handle	Price	Handle Only	
	Item No.	Item No.		Item No.		No.	Price
M2.5 X 0.45	M207200	M217200	\$ 87.86	M207221	\$ 192.91	2W	\$ 18.82
M3.0 X 0.50	M207300	M217300	82.13	M207321	181.45	2W	18.82
M3.5 X 0.60	M207400	M217400	68.76	M207421	154.71	2W	18.82
M4.0 X 0.70	M207500	M217500	68.76	M207521	154.71	2W	18.82
M5.0 X 0.80	M207600	M217600	68.76	M207621	156.62	3W	20.90
M6.0 X 1.00	M207700	M217700	57.30	M207721	133.70	3W	20.90
M8.0 X 1.25	M207800	M217800	57.30	M207821	135.61	4W	23.00
M8.0 X 1.60	M207900	M217900	57.30	M207921	135.61	4W	23.00
M10.0 X 1.50	M208000	M218000	64.94	M208021	150.89	4W	23.00
M10.0 X 1.25	M208100	M218100	64.94	M208121	150.89	4W	23.00
M12.0 X 1.75	M208300	M218300	64.94	M208321	152.80	5W	25.09
M12.0 X 1.25	M208500	M218500	64.94	M208521	152.80	5W	25.09
M14.0 X 2.00	M208700	M218700	76.40	M208721	177.63	6W	27.18
M14.0 X 1.50	M208800	M218800	76.40	M208821	177.63	6W	27.18
M16.0 X 2.00	M209000	M219000	76.40	M209021	177.63	6W	27.18
M16.0 X 1.50	M209100	M219100	76.40	M209121	177.63	6W	27.18
M18.0 X 1.50	M209300	M219300	87.86	M209321	206.28	7W	33.45

METRIC - INCH PITCH EQUIVALENTS

Pitch mm	Pitch in Inches	Threads Per Inch	Pitch mm	Pitch in Inches	Threads Per Inch
0.35	.01378	72.57	1.25	.04921	20.32
0.40	.01575	63.50	1.50	.05906	16.93
0.45	.01772	56.44	1.75	.06890	14.51
0.50	.01969	50.80	2.00	.07874	12.70
0.60	.02362	42.33	2.50	.09843	10.16
0.70	.02756	36.29	3.00	.11811	8.46
0.75	.02953	33.87	4.00	.15748	6.35
0.80	.03150	31.75	4.50	.17717	5.64
0.90	.03543	28.22	5.00	.19685	5.08
1.00	.03937	25.40	6.00	.23622	4.23



METRIC THREAD RING GAGES

- Standard in 6g Tolerance.
- Manufactured from selected steels to American Gage Design (AGD Style).
- Machined and accurately lapped for an exacting thread size.
- Meticulously inspected in every element.
- Best if purchased with and mated to a setting plug gage at the time of order.
- NOGO rings are furnished with an identifying groove around the rim of the gage.
- Optional Thread Ring Gage Holders available.
- Chrome Plate Rings, add 50%.
- Left hand available, price on application.
- Larger sizes available, price on application

HOW TO ORDER

1. Standard in 6g tolerance.
2. Setting Plugs should be ordered at the same time as the corresponding ring gages.
3. Ring Gages will be set with new Set Plug before shipping.
4. Chrome available on rings, add 100%.
5. Left hand available, price on application.
6. Larger sizes available, price on application.
7. Specials available, price on application.

METRIC THREAD RINGS **Product Group #19-00MR**

Nominal Size Pitch mm	GO Ring Item No.	NOGO Ring Item No.	Price	GO-NOGO w/o holder		Holder	
				Item No.	Price	Size	Price
M1.6 X 0.35	M27100901	M27100913	\$ 234.93	M27100963	\$ 469.86	1	\$29.27
M1.8 X 0.35	M27101101	M27101113	234.93	M27101163	469.86	1	29.27
M2.0 X 0.40	M27101301	M27101313	212.01	M27101363	424.02	1	29.27
M2.2 X 0.45	M27101501	M27101513	212.01	M27101563	424.02	1	29.27
M2.5 X 0.45	M367200	M377200	212.01	M367237	424.02	1	29.27
M3.0 X 0.50	M367300	M377300	183.36	M367337	366.72	1	29.27
M3.5 X 0.60	M367400	M377400	183.36	M367437	366.72	1	29.27
M4.0 X 0.70	M367500	M377500	169.99	M27102563	339.98	1	29.27
M4.5 X 0.75	M27102501	M27102513	169.99	M367537	339.98	1	29.27
M5.0 X 0.80	M367600	M377600	169.99	M367637	339.98	1	29.27
M6.0 X 1.00	M367700	M377700	156.62	M367737	313.24	2	33.45
M7.0 X 1.00	M27103201	M27103213	156.62	M27103263	313.24	2	33.45
M8.0 X 1.25	M367800	M377800	156.62	M367837	313.24	2	33.45
M8.0 X 1.00	M367900	M377900	156.62	M367937	313.24	2	33.45
M10.0 X 1.50	M368000	M378000	169.99	M368037	339.98	3	37.63
M10.0 X 1.25	M368100	M378100	169.99	M368137	339.98	3	37.63
M12.0 X 1.75	M368300	M378300	181.45	M368337	362.90	3	37.63
M12.0 X 1.50	M368400	M378400	181.45	M368437	362.90	3	37.63
M12.0 X 1.25	M368500	M378500	202.46	M368537	362.90	3	37.63
M14.0 X 2.00	M368700	M378700	202.46	M368737	404.92	4	45.99
M14.0 X 1.50	M368800	M378800	202.46	M368837	404.92	4	45.99
M16.0 X 2.00	M369000	M379000	202.46	M369037	404.92	4	45.99
M16.0 X 1.50	M369100	M379100	202.46	M369137	404.92	4	45.99
M17.0 X 1.00	M369200	M379200	271.22	M369237	542.43	4	45.99
M18.0 X 2.50	M27106201	M27106213	271.22	M27106263	542.43	4	45.99
M18.0 X 1.50	M369300	M379300	271.22	M369337	542.43	4	45.99
M20.0 X 2.50	M369400	M379400	336.16	M369437	672.31	4	45.99
M20.0 X 1.50	M369500	M379500	336.16	M369537	672.31	4	45.99
M22.0 X 2.50	M27107001	M27107013	343.80	M27107063	687.59	5	58.53
M22.0 X 1.50	M27107201	M27107213	343.80	M27107263	687.59	5	58.53
M24.0 X 3.00	M27107401	M27107413	395.37	M27107463	790.73	5	58.53
M24.0 X 2.00	M27107501	M27107513	395.37	M27107563	790.73	5	58.53
M27.0 X 3.00	M27108201	M27108213	412.56	M27108263	825.11	5	58.53
M27.0 X 2.00	M27108301	M27108313	412.56	M27108363	825.11	5	58.53
M30.0 X 3.50	M27108901	M27108913	418.29	M27108963	836.57	6	71.07
M30.0 X 2.00	M27109101	M27109113	418.29	M27109163	836.57	6	71.07
M33.0 X 3.50	M27109601	M27109613	462.22	M27109663	924.43	6	71.07
M33.0 X 2.00	M27109801	M27109813	462.22	M27109863	924.43	6	71.07
M36.0 X 4.00	M27110101	M27110113	517.60	M27110163	1,035.21	6	71.07
M36.0 X 3.00	M27110201	M27110213	517.60	M27110263	1,035.21	6	71.07



METRIC THREAD SETTING PLUGS

- Standard in 6g Tolerance.
- Left hand available, price on application.
- Larger sizes available, price on application

HOW TO ORDER

1. Standard in 6g Tolerance.
2. Specify Quantity.
3. Handles are not included with single members. If handles are required for GO or NOGO members, specify "with handles" at time of order.
4. Setting Plugs should be ordered at the same time as the corresponding ring gages.
5. Request Ring Gages be set with new Set Plug before shipping.
6. For class "W" tolerance, add 25%.
7. Left hand available, price on application.
8. Specials available, price on application.
9. When ordering please use item numbers.

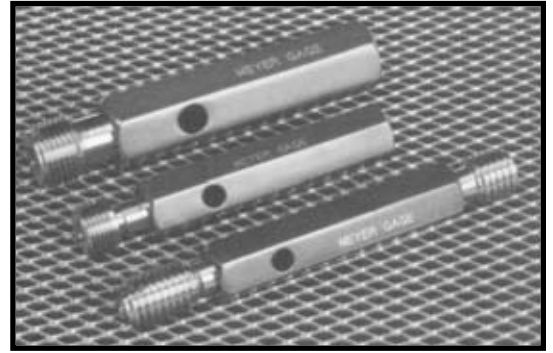

TRUNCATED SETTING PLUGS

Product Group #19-00MS

Metric Size Pitch mm	GO Member Item No.	NOGO Member Item No.	Price	Double End w/Handle		Handle Only	
				Item No.	Price	No	Price
M1.6 X 0.35	M23600901	M23600913	\$164.26	M23600963	\$ 343.80	000	\$16.72
M1.8 X 0.35	M23601101	M23601113	164.26	M23601163	343.80	000	16.72
M2.0 X 0.40	M23601301	M23601313	154.71	M23601363	324.70	000	16.72
M2.2 X 0.45	M23601501	M23601513	154.71	M23601563	324.70	000	16.72
M2.5 X 0.45	M387200	M397200	154.71	M387239	324.70	000	16.72
M3.0 X 0.50	M387300	M397300	150.89	M387339	317.06	00	16.72
M3.5 X 0.60	M387400	M397400	150.89	M387439	317.06	00	16.72
M4.0 X 0.70	M387500	M397500	145.16	M387539	305.59	0	16.72
M4.5 X 0.75	M23602501	M23602513	145.16	M23602563	305.59	0	16.72
M4.5 X 0.75	M387600	M397600	131.96	M387639	277.82	0	15.20
M6.0 X 1.00	M387700	M397700	129.87	M387739	275.04	1	16.72
M7.0 X 1.00	M23603201	M23603213	129.87	M23603263	275.04	1	16.72
M8.0 X 1.25	M387800	M397800	129.87	M387839	275.04	1	16.72
M8.0 X 1.00	M387900	M397900	129.87	M387939	275.04	1	16.72
M10.0 X 1.50	M388000	M398000	139.43	M388039	294.14	2	16.72
M10.0 X 1.25	M388100	M398100	139.43	M388139	294.14	2	16.72
M12.0 X 1.75	M388300	M398300	145.16	M388339	305.59	2	16.72
M12.0 X 1.50	M388400	M398400	145.16	M388439	305.59	2	16.72
M12.0 X 1.25	M388500	M398500	145.16	M388539	305.59	2	16.72
M14.0 X 2.00	M388700	M398700	168.07	M388739	351.44	3	16.72
M14.0 X 1.50	M388800	M398800	168.07	M388839	351.44	3	16.72
M16.0 X 2.00	M389000	M399000	168.07	M389039	351.44	3	16.72
M16.0 X 1.50	M389100	M399100	168.07	M389139	351.44	3	16.72
M17.0 X 1.00	M389200	M399200	187.17	M389239	389.63	3	16.72
M18.0 X 2.50	M23606201	M23606213	187.17	M23606263	389.63	3	16.72
M18.0 X 1.50	M389300	M399300	187.17	M389339	389.63	3	16.72
M20.0 X 2.50	M389400	M399400	187.17	M389439	389.63	3	16.72
M20.0 X 1.50	M389500	M399500	187.17	M389539	389.63	3	16.72
M22.0 X 2.50	M23607001	M23607013	261.67	M23607063	538.62	4	16.72
M22.0 X 1.50	M23607201	M23607213	261.67	M23607263	538.62	4	16.72
M24.0 X 3.00	M23607401	M23607413	265.49	M23607463	546.25	4	16.72
M24.0 X 2.00	M23607501	M23607513	265.49	M23607563	546.25	4	16.72
M27.0 X 3.00	M23608201	M23608213	282.68	M23608263	580.64	4	16.72
M27.0 X 2.00	M23608301	M23608313	282.68	M23608363	580.64	4	16.72
M30.0 X 3.00	M23608901	M23608913	290.31	M23608963	597.83	5	18.82
M30.0 X 2.00	M23609101	M23609113	290.31	M23609163	597.83	5	18.82
M33.0 X 3.50	M23609601	M23609613	301.78	M23609663	620.74	5	18.82
M33.0 X 2.00	M23609801	M23609813	301.78	M23609863	620.74	5	18.82
M36.0 X 4.00	M23610101	M23610113	328.51	M23610163	674.23	5	18.82
M36.0 X 3.00	M23610201	M23610213	328.51	M23610263	674.23	5	18.82



TAPER PIPE GAGES — NPT

American National Taper Pipe Thread Gages (NPT) are furnished to thread specifications which are in agreement with the National Institute of Standards and Technology American Gage Design dimensions as shown below.

Master and reference gages can be furnished on request.

TAPER PIPE GAGES - NPT

- (NPT) are furnished American National Pipe Thread NPT TAPER PIPE GAGES made to American Gage Dimensions (AGD).
- To thread specifications which are in agreement with National Institute of Standards.
- Larger sizes and ANPT available upon request.

ADDITIONAL PIPE THREAD GAGES

- Straight Pipe: NPSF, NPSL, NPSC, NPSM and other special pipe gages available upon request.

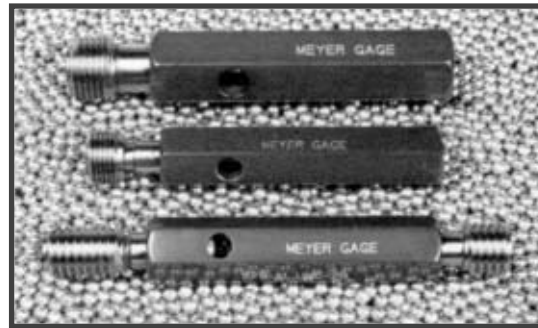

TAPER PIPE GAGES - NPT DIMENSIONS RING DIMENSIONS

Nominal Size	Plug Dimensions				D Taper- Lock Only	No.	Handle H		Ring Dimensions			
	Length Member L ₁ to Notch Tolerance	Length L ₂ Min.	Length	Minus			Length	Hex	Nominal Size	Thickness L ₁ Thin	Tolerance Plus	A Outside Dia.
1/16	27	.1600	.001	.261	1/4	1	2-3/4	3/8	1/16	.1600	.001	1-1/8
1/8	27	.1615	.001	.264	1/4	2	3	1/2	1/8	.1615	.001	1-1/8
1/4	18	.2278	.001	.402	1/4	3	3-1/4	11/16	1/4	.2278	.001	1-3/8
3/8	18	.2400	.001	.408	1/4	3	3-1/4	11/16	3/8	.2400	.001	1-1/2
1/2	14	.3200	.001	.534	5/16	4	3-5/8	7/8	1/2	.3200	.001	1-3/4
3/4	14	.3390	.001	.546	5/16	4	3-5/8	7/8	3/4	.3390	.001	2
1	11-1/2	.4000	.001	.683	3/8	5	4	1	1	.4000	.001	2-1/2
1-1/4	11-1/2	.4200	.001	.707	3/8	5	4	1	1-1/4	.4200	.001	3
1-1/2	11-1/2	.4200	.001	.723	3/8	5	4	1	1-1/2	.4200	.001	3-1/4
2	11-1/2	.4360	.001	.757	3/8	5	4	1	2	.4360	.001	3-3/4
2-1/2	8	.6820	.002	1.138	—	6	5	1-1/8	2-1/2	.6820	.002	4-1/4
3	8	.7660	.002	1.200	—	6	5	1-1/8	3	.7660	.002	5

L₁ SINGLE END PLUG GAGES - NPT #19-00TP L₁ THIN RING GAGES - NPT #19-00TP

Nominal Size	L ₁ Plug Gage		L ₁ Plug Gage w/Handle		Handle		Nominal Size	L ₁ Thin Ring Gages			
	Item No.	Price	Item No.	Price	No.	Price		Item No.	Price		
1/16	27	M701140	\$ 116.51	M7011401	\$ 131.79	1	\$ 16.72	1/16	27	M701152	\$215.83
1/8	27	M701141	80.22	M7011411	95.50	2	16.72	1/8	27	M701153	150.89
1/4	18	M701142	91.68	M7011421	106.96	3	16.72	1/4	18	M701154	166.17
3/8	18	M701143	105.05	M7011431	120.32	3	16.72	3/8	18	M701155	191.01
1/2	14	M701144	118.42	M7011441	135.62	4	18.82	1/2	14	M701156	212.02
3/4	14	M701145	133.70	M7011451	150.90	4	18.82	3/4	14	M701157	242.57
1	11-1/2	M701146	150.89	M7011461	168.07	5	18.82	1	11-1/2	M701158	275.04
1-1/4	11-1/2	M701147	166.17	M7011471	183.37	5	18.82	1-1/4	11-1/2	M701159	299.87
1-1/2	11-1/2	M701148	189.08	M7011481	206.28	5	18.82	1-1/2	11-1/2	M701160	357.17
2	11-1/2	M701149	229.19	M7011491	246.40	5	18.82	2	11-1/2	M701161	427.83
2-1/2	8	M701150	275.04	M7011501	303.69	6	31.36	2-1/2	8	M701162	502.32
3	8	M701151	322.79	M7011511	351.45	6	31.36	3	8	M701163	624.57



NPTF (Dryseal) Taper Pipe Gages

Dryseal pipe threads are generally used in more critical applications than NPT and, therefore, a greater variety of gages and/or measuring equipment is used to more adequately check size, taper, and thread form.

- L_1 and L_3 plugs supplied with 1 step as standard
- L_1 = Length of engagement in hand tight make up
- L_2 = Length of effective thread (external)
- L_3 = Length of 3 threads beyond L_1 for wrench make up.

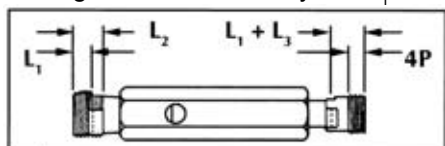

• Plug Dimensions

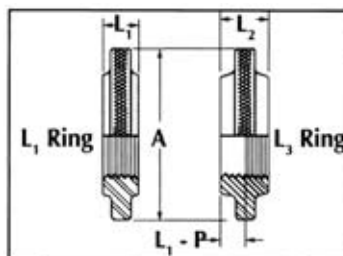

• Ring Dimensions

TAPER PIPE GAGES — NPTF DIMENSIONS

Nominal Size	To Basic Notch	Length Member L_1 and L_2				Tol. Minus	Handle No.	Nominal Size	Outside Diameter	Thickness		
		Tol. Minus	Full Length (Min)	L_2	$L_1 + L_2$					L_1 Thin	L_2 Thick	Tol. Plus
1/16	.1600	.001	.26113	.2711	.001	1	1/16	1-1/8	.1600	.26113	.001	
1/8	.1615	.001	.26385	.2726	.001	2	1/8	1-1/8	.1615	.26385	.001	
1/4	.2278	.001	.40178	.3945	.001	3	1/4	1-3/8	.2278	.40178	.001	
3/8	.2400	.001	.40778	.4067	.001	3	3/8	1-1/2	.2400	.40778	.001	
1/2	.3200	.001	.53371	.5343	.001	4	1/2	1-3/4	.3200	.53371	.001	
3/4	.3390	.001	.54571	.5533	.001	4	3/4	2	.3390	.54571	.001	
1	.4000	.001	.68278	.6609	.001	5	1	2-1/2	.4000	.68278	.001	
1-1/4	.4200	.001	.70678	.6809	.001	5	1-1/4	3	.4200	.70678	.001	
1-1/2	.4200	.001	.72348	.6809	.001	5	1-1/2	3-1/4	.4200	.72348	.001	
2	.4360	.001	.75652	.6969	.001	5	2	3-3/4	.4360	.75652	.001	
2-1/2	.6820	.002	1.13750	1.0570	.002	6	2-1/2	4-1/4	.6820	1.13750	.002	
3	.7660	.002	1.20000	1.1410	.002	6	3	5	.7660	1.20000	.002	

TAPER PIPE GAGES — NPTF

Product Group #19-00TPF

Nominal Size	L_1 Ring Gage Member Only		L_2 Ring Gage Member Only		NPTF 6 Step Plug Gage Member Only		w/Handle		NPTF 6 Step Ring Gage		
	Item No.	Price	Item No.	Price	Item No.	Price	Item No.	Price	Item No.	Price	
1/16	27	M701185	\$ 227.29	M701192	\$ 318.97	M701178	\$ 231.11	M7011781	\$ 246.39	M701199	\$ 380.09
1/8	27	M701186	158.53	M701193	307.51	M701179	231.11	M7011791	246.39	M701200	380.09
1/4	18	M701187	189.09	M701194	318.97	M701180	231.11	M7011801	246.39	M701201	380.09
3/8	18	M701188	200.55	M701195	336.16	M701181	231.11	M7011811	246.39	M701202	380.09
1/2	14	M701189	223.47	M701196	349.53	M701182	231.11	M7011821	246.39	M701203	380.09
3/4	14	M701190	254.03	M701197	383.91	M701183	244.48	M7011831	259.76	M701204	425.93
1	11-1/2	M701191	288.41	M701198	418.29	M701184	265.49	M7011841	282.68	M701205	425.93
1-1/4	11-1/2	M31600801	313.24	M31600804	458.40	M31100807	297.96	M31100857	315.15	M31600807	431.66
1-1/2	11-1/2	M31600901	374.36	M31600904	502.33	M31100907	328.52	M31100957	345.71	M31600907	494.69
2	11-1/2	M31601001	446.94	M31601004	586.36	M31101007	458.40	M31101057	475.59	M31601007	601.64
2-1/2	8	M31601101	525.24	M31601104	704.78	M31101107	691.41	M31101157	714.33	M31601107	720.06
3	8	M31601201	655.12	M31601204	827.02	M31101207	754.44	M31101257	777.36	M31601207	865.22

Nominal Size	L_1 Plug Gage Member Only		w/Handle		L_3 Plug Gage Member Only		w/Handle		L_1 & L_3 Double End w/Handle		
	Item No.	Price	Item No.	Price	Item No.	Price	Item No.	Price	Item No.	Price	
1/16	27	M701164	\$ 154.71	M7011641	\$ 169.99	M701171	\$ 154.71	M7011711	\$ 169.99	M37401	\$ 326.70
1/8	27	M701165	108.87	M7011651	124.15	M701172	108.87	M7011721	124.15	M37403	233.02
1/4	18	M701166	129.88	M7011661	145.16	M701173	129.88	M7011731	145.16	M37405	275.04
3/8	18	M701167	154.71	M7011671	169.99	M701174	154.71	M7011741	169.99	M37407	324.70
1/2	14	M701168	175.72	M7011681	191.00	M701175	175.72	M7011751	191.00	M37409	366.72
3/4	14	M701169	194.82	M7011691	210.10	M701176	194.82	M7011761	210.10	M37411	404.92
1	11-1/2	M701170	213.92	M7011701	231.11	M701177	213.92	M7011771	231.11	M37413	445.03
1-1/4	11-1/2	M31100801	242.57	M31100851	259.76	M31100804	242.57	M31100854	259.76	M31100863	502.33
1-1/2	11-1/2	M31100901	275.04	M31100951	292.23	M31100904	275.04	M31100954	292.23	M31100963	567.26
2	11-1/2	M31101001	328.52	M31101051	345.71	M31101004	328.52	M31101054	345.71	M31101063	674.22
2-1/2	8	M31101101	435.48	M31101151	458.40	M31101104	435.48	M31101154	458.40	M31101163	893.87
3	8	M31101201	525.24	M31101251	548.16	M31101204	525.24	M31101254	548.16	M31101263	1,073.41



DECIMAL AND METRIC EQUIVALENTS

Drill Size	Decimal	MM	Drill Size	Decimal	MM	Drill Size	Decimal	MM	Drill Size	Decimal	MM	Drill Size	Decimal	MM
80	0.0135	0.343		0.0538	1.367	28	0.1405	3.569	A	0.2340	5.944	27/64"	0.4219	10.716
79	0.0145	0.368	54	0.0550	1.397	9/64"	0.1406	3.572	15/64"	0.2344	5.953	7/16"	0.4375	11.113
1/64"	0.0156	0.397	53	0.0595	1.511	27	0.1440	3.658	B	0.2380	6.045	29/64"	0.4531	11.509
78	0.0160	0.406		0.0598	1.519	26	0.1470	3.734		0.2391	6.073	15/32"	0.4688	11.906
	0.0164	0.417	1/16"	0.0625	1.588	25	0.1495	3.797	C	0.2420	6.147	31/64"	0.4844	12.303
	0.0179	0.455	52	0.0635	1.613	24	0.1520	3.861	D	0.2460	6.248	1/2"	0.5000	12.700
77	0.0180	0.457	51	0.0670	1.702	23	0.1540	3.912	1/4"	0.2500	6.350	33/64"	0.5156	13.097
76	0.0200	0.508		0.0673	1.709	5/32"	0.1563	3.969	E	0.2500	6.350	17/32"	0.5313	13.494
	0.0209	0.531	50	0.0700	1.778	22	0.1570	3.988	F	0.2570	6.528	35/64"	0.5469	13.891
75	0.0210	0.533	49	0.0730	1.854	21	0.1590	4.039	G	0.2610	6.629	9/16"	0.5625	14.288
74	0.0225	0.572		0.0747	1.897	20	0.1610	4.089	17/64"	0.2656	6.747	37/64"	0.5781	14.684
	0.0239	0.607	48	0.0760	1.930		0.1644	4.176	H	0.2660	6.756	19/32"	0.5938	15.081
73	0.0240	0.610	5/64"	0.0781	1.984	19	0.1660	4.216	I	0.2720	6.909	39/64"	0.6094	15.478
72	0.0250	0.635	47	0.0785	1.994	18	0.1695	4.305	J	0.2770	7.036	5/8"	0.6250	15.875
71	0.0260	0.660	46	0.0810	2.057	11/64"	0.1719	4.366	K	0.2810	7.137	41/64"	0.6406	16.272
	0.0269	0.683	45	0.0820	2.083	17	0.1730	4.394	9/32"	0.2813	7.144	21/32"	0.6563	16.669
70	0.0280	0.711	44	0.0860	2.184	16	0.1770	4.496	L	0.2900	7.366	43/64"	0.6719	17.066
69	0.0292	0.742	43	0.0890	2.261		0.1793	4.554	M	0.2950	7.493	11/16"	0.6875	17.463
	0.0299	0.759		0.0897	2.278	15	0.1800	4.572	19/64"	0.2969	7.541	45/64"	0.7031	17.859
68	0.0310	0.787	42	0.0935	2.375	14	0.1820	4.623	N	0.3020	7.671	23/32"	0.7188	18.256
1/32"	0.0313	0.794	3/32"	0.0938	2.381	13	0.1850	4.699	5/16"	0.3125	7.938	47/64"	0.7344	18.653
67	0.0320	0.813	41	0.0960	2.438	3/16"	0.1875	4.763	O	0.3160	8.026	3/4"	0.7500	19.050
	0.0329	0.836	40	0.0980	2.489	12	0.1890	4.801	P	0.3230	8.204	49/64"	0.7656	19.447
66	0.0330	0.838	39	0.0995	2.527	11	0.1910	4.851	21/64"	0.3281	8.334	25/32"	0.7813	19.844
65	0.0350	0.889	38	0.1015	2.578	10	0.1935	4.915	Q	0.3320	8.433	51/64"	0.7969	20.241
	0.0359	0.912	37	0.1040	2.642		0.1943	4.935	R	0.3390	8.611	13/16"	0.8125	20.638
64	0.0360	0.914		0.1046	2.657	9	0.1960	4.978	11/32"	0.3438	8.731	53/64"	0.8281	21.034
63	0.0370	0.940	36	0.1065	2.705	8	0.1990	5.055	S	0.3480	8.839	27/32"	0.8438	21.431
62	0.0380	0.965	7/64"	0.1094	2.778	7	0.2010	5.105	T	0.3580	9.093	55/64"	0.8594	21.828
61	0.0390	0.991	35	0.1100	2.794	13/64"	0.2031	5.159	23/64"	0.3594	9.128	7/8"	0.8750	22.225
60	0.0400	1.016	34	0.1110	2.819	6	0.2040	5.182	U	0.3680	9.347	57/64"	0.8906	22.622
59	0.0410	1.041	33	0.1130	2.870	5	0.2055	5.220	3/8"	0.3750	9.525	29/32"	0.9063	23.019
	0.0418	1.062	32	0.1160	2.946	4	0.2090	5.309	V	0.3770	9.576	59/64"	0.9219	23.416
58	0.0420	1.067		0.1196	3.038		0.2092	5.314	W	0.3860	9.804	15/16"	0.9375	23.813
57	0.0430	1.092	31	0.1200	3.048	3	0.2130	5.410	25/64"	0.3906	9.922	61/64"	0.9531	24.209
56	0.0465	1.181	1/8"	0.1250	3.175	7/32"	0.2188	5.556	X	0.3970	10.084	31/32"	0.9688	24.606
3/64"	0.0469	1.191	30	0.1285	3.264	2	0.2210	5.613	Y	0.4040	10.262	63/64"	0.9844	25.003
	0.0478	1.214		0.1345	3.416		0.2242	5.695	13/32"	0.4063	10.319	1	1.0000	25.400
55	0.0520	1.321	29	0.1360	3.454	1	0.2280	5.791	Z	0.4130	10.490			

TAP DRILL SIZES

THREAD	DRILL	THREAD	DRILL	THREAD	DRILL	THREAD	DRILL
0-80	3/64	7/16-14	U	6-40	No. 33	1-8	7/8
1-64	No. 53	7/16-20	W	8-32	No. 29	1-14	15/16
1-72	No. 53	1/2-13	27/64	8-36	No. 29	1-1/8-7	63/64
2-56	No. 51	1/2-20	29/64	10-24	No. 25	1-1/8-12	1-3/64
2-64	No. 50	9/16-12	31/64	10-32	No. 21	1-1/4-7	1-7/64
3-48	No. 47	9/16-18	33/64	12-24	No. 17	1-1/4-12	1-11/64
3-56	No. 46	5/8-11	17/32	12-28	No. 15	1-1/2-6	1-11/32
4-40	No. 43	5/8-18	37/64	1/4-20	No. 7	1-1/2-12	1-27/64
4-48	No. 42	3/4-10	21/32	1/4-28	No. 3	1-3/4-5	1-35/64
5-40	No. 39	3/4-16	11/16	5/16-18	F	1-3/4-12	1-43/64
5-44	No. 37	7/8-9	49/64	5/16-24	I	2 - 4-1/2	1-25-32
6-32	No. 36	7/8-14	13/16	3/8-16	5/16	2-12	1-59-64
6-40	No. 33	1-8	7/8	3/8-24	Q	2-1/4-4-1/2	2-1/32

TAPER PIPE

THREAD	DRILL	THREAD	DRILL
1/8-27	R	1-1/2-11-1/2	1-47/64
1/4-18	7/16	2-11-1/2	2-7/32
3/8-18	37/64	2-1/2-8	2-5/8
1/2-14	23/32	3-8	3-1/4
3/4-14	59/64	3-1/2-8	3-3/4
1-111/2	1-5/32	4-8	4-1/4
1-1/4-11-1/2	1-1/2		





Meyer branded gages are made in the USA. *Black OX* branded gages are assembled in the USA.

ORDERING INFORMATION:

Visit our distributor locator at www.meyergage.com to find your local distributor, or call our customer service department at 800-243-7087

MINIMUM ORDER CHARGE:

There is a twenty dollar minimum charge (USA only) \$50 minimum for outside the US.

RETURNS AND EXCHANGES:

An RMA is required for all exchanges and returns. Please contact our customer service department for assistance.

PREMIUM FACTORY PROCESSING (PFP*)

Meyer Gage offers this optional service on many of our products. To further our commitment to you, we offer this service at a cost of 35% added to the total net order value. Dependent on the time, quantity, and complexity of your order our customer service department can quote an expedited lead time for you. While Meyer Gage cannot guarantee same day shipment for all orders, we make every reasonable effort to meet your shortened deadlines. (Shipping charges from the carrier of our choice are in addition to this service)

**If shipment is not made within promised lead time the item(s) will be charged at normal price, and Meyer Gage Co., Inc. Liability for direct, indirect, special or consequential damages for such failure will be limited to the premium charge only.*

Complete Customer Satisfaction is our Goal.



Meyer Gage Company, Inc.

230 Burnham Street, South Windsor, CT 06074

Tel. 860 528-6526

Toll Free 1-800 243-7087

Fax 860 528-1428 (24 Hours)

www.meyergage.com